

643 663

Effective 8/17/2019

LIMITED STOP/EXPRESS BUS ROUTES



Route 643
Route 663

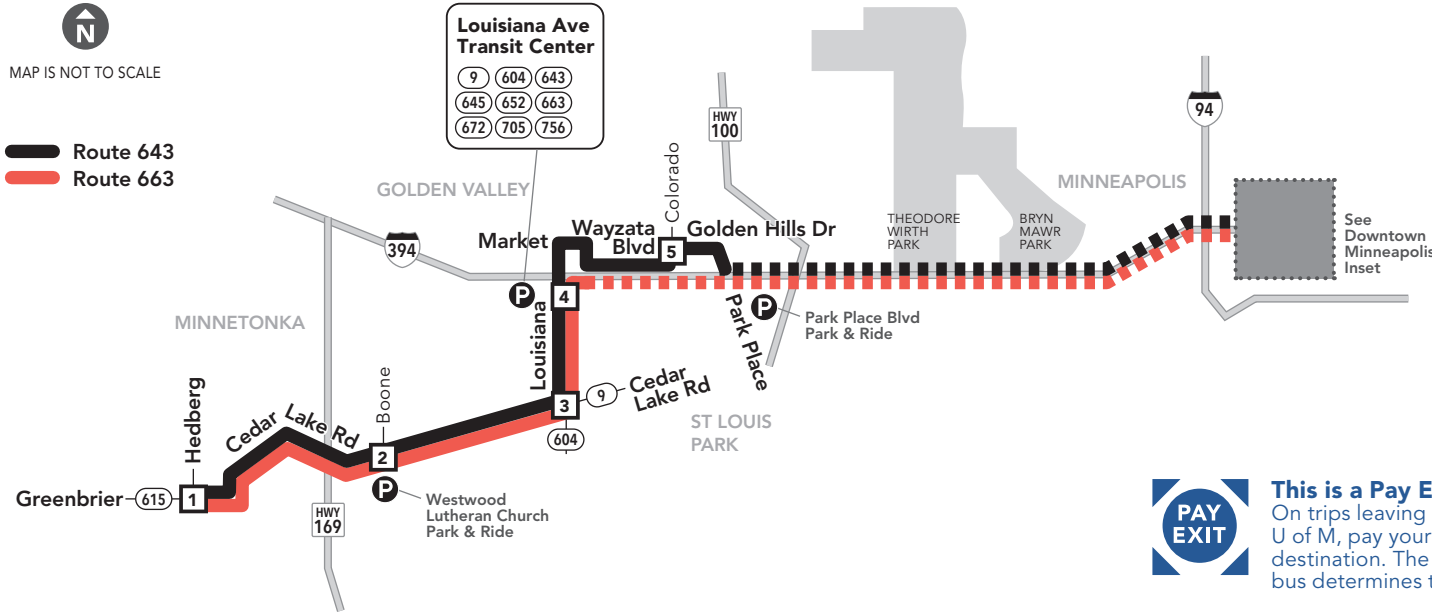

MAJOR DESTINATIONS:

Downtown Minneapolis

Golden Valley

- Golden Hills Dr
- Wayzata Blvd N
- Market St

St Louis Park

- Louisiana Ave Transit Center

Cedar Lake Rd

Minnetonka

- Greenbrier Rd

Minneapolis Downtown Zone

Ride in the Downtown Zone for 50¢

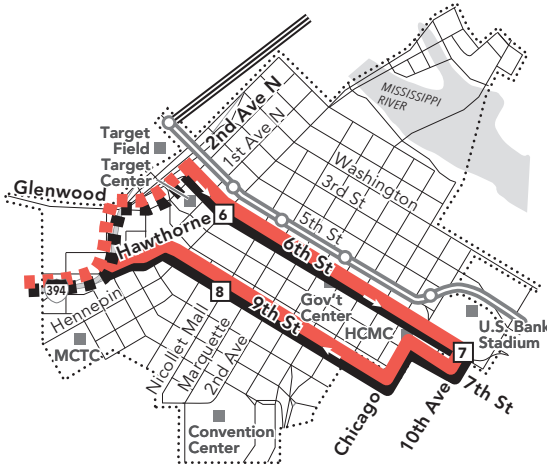

3 Timepoint on schedule
Find the timepoint nearest your stop, and use that column of the schedule. Your stop may be between timepoints.

Regular Route
Bus will pick up or drop off customers at any bus stop along this route

METRO Line and Stations
METRO trains or buses will pick up or drop off customers at any station along this route.

Northstar Commuter Line
Transfers from Northstar to buses or light rail are free. Transfers from buses or light rail to Northstar require an additional fare.

Non-Stop Service
Bus does not pick up or drop off customers on these route segments.

Connecting Routes
See those route schedules for details.

Park & Ride Lot
Park free at these lots while you commute.



This is a Pay Exit route.
On trips leaving downtown or the U of M, pay your fare at your destination. The time you exit the bus determines the fare amount.

Park & Ride Locations

Park free at these lots while you commute. No overnight parking.

ST LOUIS PARK

- Louisiana Ave Transit Center: 1300 Louisiana Ave S
- Park Place Blvd Park & Ride: 1500 Park Place Blvd S
- Westwood Lutheran Church Park & Ride: 9001 Cedar Lake Rd

Metro Transit Mobile App

Now you can plan your trip, see arrival information for bus and trains and buy transit tickets all on the go!



Download the free app on Google Play or iTunes.

Reading a schedule: a step-by-step guide

- Find the schedule for the day of the week and the direction you plan to travel.
- Look at the map and find the timepoints nearest your trip start and end points. Your stop may be between timepoints.
- Read down the column to see what time a bus will depart from a given timepoint. Read across a row to see when the bus will reach another timepoint. If the time is blank, that trip does not serve that timepoint.

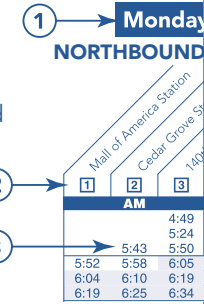

Not all stops are shown on this timetable.

Use the timepoints on the map and the schedule to estimate the arrival of your bus. For details, call Transit Information or explore our interactive map and trip planning tools at metrotransit.org.

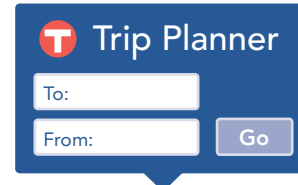

metrotransit.org

Local Bus & METRO Fares	Rush Hours Mon.-Fri. 6:00-9:00 am 3:00-6:30 pm	Non-Rush Hours
Adults (ages 13-64)	\$ 2.50	\$ 2.00
Seniors (65+), Youth (6-12), Medicare	\$ 2.50	\$ 1.00
Downtown Zone	\$.50	\$.50
Express Bus Fares	Rush Hours	Non-Rush Hours
Adults (ages 13-64)	\$ 3.25	\$ 2.50
Seniors (65+), Youth (6-12), Medicare	\$ 3.25	\$ 1.00
Reduced Fares		
Persons with disabilities	\$ 1.00 At all times on buses & METRO lines	
Children 5 and Under	FREE (limit 3) Must ride with a fare-paying customer	

Reduced Fares

See rates above. To receive a reduced fare:
Bus – Please tell the bus driver **before you pay your fare** if you qualify for a reduced fare.
METRO lines – be ready to show police officers that you qualify for a reduced fare.

Qualifying ID

Seniors (65+): Show a Minnesota driver's license/state ID with a T endorsement.
Medicare card holders: Show a Medicare card along with a MN driver's license/state ID.
Persons with Disabilities: Show your Metro Mobility card or transfer, Metro Transit temporary ID with a photo ID or Minnesota driver's license/state ID with an A or L endorsement. For information on certification, call Customer Relations at 612-373-3333.

Fare Cards/Passes Buy a variety of passes at Metro Transit service centers, retail outlets or online. Or buy tickets via Metro Transit's Mobile App.

Fareboxes Buses accept U.S. bills and coins. Change is not available.

Transfers All fares (excluding the Downtown Zone) include a transfer. This gives you unlimited rides on buses and METRO lines for 2 ½ hours. Ask for one when you pay your cash fare. Transfers are automatically embedded on fare cards and METRO tickets.



612-373-3333 • metrotransit.org

Route 643

Monday — Friday

EASTBOUND from Minnetonka to downtown Minneapolis

	Downtown Minneapolis						
	route number and letter	Hedberg Dr and Greenbrier Rd	Cedar Lake Rd and Boone Ave	Louisiana Ave and Cedar Lake Rd	Louisiana Ave Transit Center	Golden Hills Dr and Colorado Ave	6th St and Hennepin Ave
	1	2	3	4	5	6	7
	PM						
643	—	—	—	3:08	3:12	3:23	3:31
643	3:50	3:54	3:58	—	4:03	4:15	4:23
643	4:23	4:27	4:31	—	4:36	4:49	4:57
643	—	—	—	5:08	5:12	5:25	5:33
643	5:55	5:59	6:03	—	6:08	6:19	6:27

Shaded times denote rush-hour service. See fare panel for rush-hour fees.

Monday — Friday

WESTBOUND from downtown Minneapolis to Minnetonka

	Downtown Minneapolis						
	route number and letter	6th St and 10th Ave	9th St and Nicollet Mall	Golden Hills Dr and Colorado Ave	Louisiana Ave and Cedar Lake Rd	Cedar Lake Rd and Boone Ave	Hedberg Dr and Greenbrier Rd
	7	8	5	3	2	1	
	AM						
643	6:01	6:08	6:17	6:23	6:26	6:30	
643	6:31	6:38	6:48	6:54	6:57	7:01	
643	7:01	7:08	7:19	7:25	7:28	7:32	
643	7:29	7:38	7:50	7:56	7:59	8:03	
643	8:29	8:38	8:49	8:55	8:58	9:02	

Shaded times denote rush-hour service. See fare panel for rush-hour fees.

Route 663

Monday — Friday

EASTBOUND from Minnetonka to downtown Minneapolis

	Downtown Minneapolis						
	route number and letter	Hedberg Dr and Greenbrier Rd	Cedar Lake Rd and Boone Ave	Louisiana Ave and Cedar Lake Rd	Louisiana Ave Transit Center	6th St and Hennepin Ave	6th St and 10th Ave
	1	2	3	4	6	7	
	AM						
663	6:17	6:21	6:25	6:30	6:40	6:48	
663	6:45	6:51	6:55	7:00	7:10	7:18	
663	7:13	7:19	7:23	7:28	7:40	7:48	
663	7:27	7:33	7:37	7:42	7:55	8:03	
663	7:47	7:53	7:58	8:03	8:15	8:23	
663	8:11	8:16	8:20	8:24	8:35	8:43	
663	9:14	9:18	9:22	9:26	9:35	9:43	

Shaded times denote rush-hour service. See fare panel for rush-hour fees.

Monday — Friday

WESTBOUND from downtown Minneapolis to Minnetonka

	Downtown Minneapolis						
	route number and letter	6th St and 10th Ave	9th St and Nicollet Mall	Louisiana Ave Transit Center	Louisiana Ave and Cedar Lake Rd	Cedar Lake Rd and Boone Ave	Hedberg Dr and Greenbrier Rd
	7	8	4	3	2	1	
	PM						
663	2:57	3:08	3:18	3:21	3:25	3:30	
663	3:39	3:50	4:00	4:03	4:07	4:12	
663	4:04	4:15	4:26	4:30	4:34	4:39	
663	4:30	4:42	4:55	5:00	5:04	5:09	
663	4:50	5:02	5:15	5:20	5:24	5:29	
663	5:05	5:17	5:30	5:35	5:39	5:44	
663	5:30	5:42	5:54	5:58	6:02	6:06	
663	6:11	6:22	6:33	6:36	6:40	6:44	

Shaded times denote rush-hour service. See fare panel for rush-hour fees.

Holiday service operates on New Year's Day, Memorial Day, Independence Day, Labor Day, Thanksgiving and Christmas. Service may be reduced on days before or after Independence Day, Thanksgiving, Christmas or New Year's Day. Look for details at metrotransit.org or in *Connect* on buses and trains prior to these holidays.

This schedule is subject to change. Traffic and weather conditions may delay buses. Get updates on service during severe winter weather at metrotransit.org/snow.

This document is available in alternative formats to individuals with disabilities. Call 612-349-7365 or visit metrotransit.org.

Go-To Card Retail Locations

A refillable Go-To Card is the most convenient way to travel by transit! Buy a Go-To Card or add value to an existing card at one of these locations or online.

MINNEAPOLIS

- Metro Transit Service Center: 719 Marquette Ave
- Unbank: 727 Hennepin Ave



All buses and trains have bike racks so you can bring your bicycle along.

Look for instructions on the rack. Lockers are also available for rent. Details at metrotransit.org/bike.

Information: 612-373-3333

Metro Transit is the one place for all your transportation information.

Transit Information

Get assistance from a transit expert.

Hours:

Monday – Friday: 6:30 am – 9:00 pm
 Saturday – Sunday: 8:00 am – 4:30 pm
 Holidays: 8:00 am – 4:30 pm
 (Closed Thanksgiving and Christmas Day)

NexTrip

Real-time departure information.

Customer Relations/ Lost & Found

570 6th Ave N, Minneapolis, MN 55411
 Provide comments and suggestions or check on lost items.

Hours: Mon. – Fri., 7:30 am – 5:30 pm
 Closed weekends and holidays

711 Minnesota Relay (hearing impaired)

metrotransit.org

- NexTrip, real-time departure times
- Online Trip Planner
- Interactive map
- Printable schedules
- Go-To Cards: buy, add value, check your balance or enroll in Auto Refill
- Find bicycling, carpooling and vanpooling resources
- Register for Guaranteed Ride Home

How to Ride

BUSES

1. Arrive 5 minutes before the schedule or NexTrip says your trip will depart.
2. Watch for your bus number.
3. Pay your fare as you board, except for Pay Exit routes.
4. Pull the cord above the window about 1 block before your stop to signal the driver.

METRO LINES

1. Arrive 5 minutes before the schedule or NexTrip says your trip will depart.
2. Pay BEFORE you board—touch your card to a reader on the platform or buy a ticket from the machine.
3. Push the blue button to open doors (trains only).
4. Colored METRO lines (Blue, Green, Red) stop at every station. Lettered lines (A & C) stop at stations on demand and when customers are present.

MAKING CONNECTIONS

Transfer between buses and METRO lines for up to 2½ hours with your fare.

Those who try to ride without paying will be charged with a misdemeanor and fined \$180.