



# METRO B Line Update

Midtown Business Association

Cody Olson, Community Outreach Coordinator

March 17, 2021

# B Line (Lake/ Marshall/ Selby) Bus Rapid Transit Overview

- Planned 4th arterial bus rapid transit line
- Substantial replacement of Route 21, region's second-highest ridership but slowest in-service speed
- Service every 10 minutes, approximately 20% faster than existing Route 21
- Project fully funded, targeted opening 2024

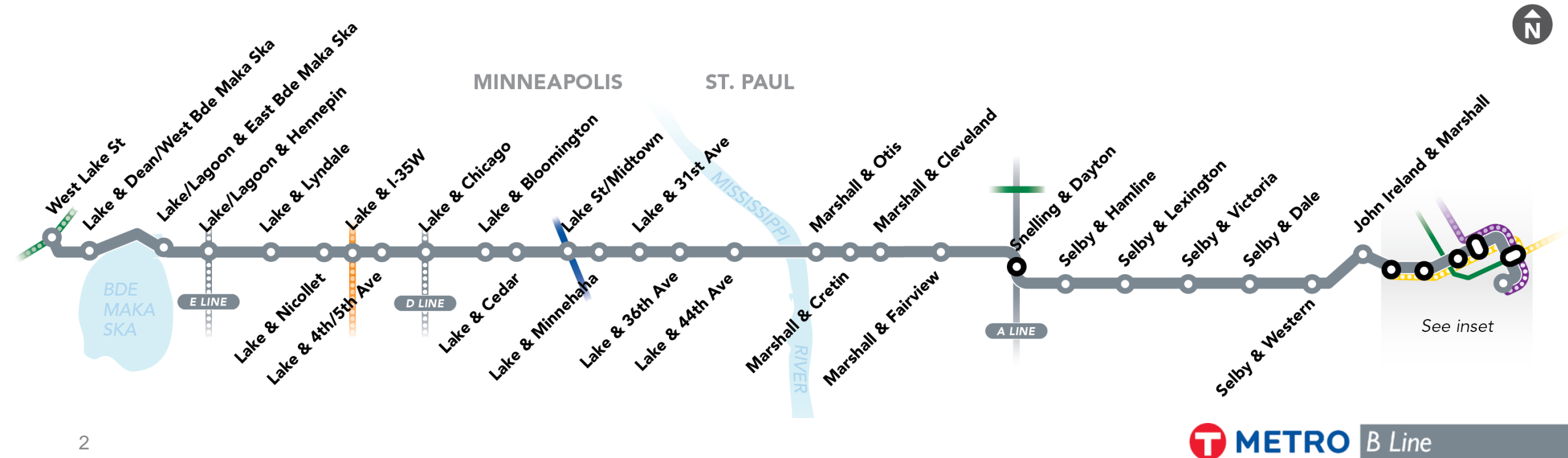

# B Line Buses



# B Line Stations

## B Line station features include:

- Real-time NexTrip signs with on-demand audible announcements
- Shelter lighting
- Push-button heating
- Containers for garbage and recycling
- Security cameras
- Emergency telephones
- Benches
- Bike parking

## What will stations look like?



**A** Pylon markers help riders identify stations from a distance.

**B** Real-time NexTrip signs provide bus information, and on-demand annunciators speak this information for people with low vision.

**C** Shelters provide weather protection and feature push-button, on-demand heaters and shelter lighting. Shelter sizes will vary based on customer demand (small shown here).

**D** Ticket machines and fare card readers collect all payment before customers board the bus.

**E** Emergency telephones provide a direct connection to Metro Transit police. Stations also feature security cameras.

**F** Stations feature trash and recycling containers.

**G** Platform edges are marked with a cast-iron textured warning strip to keep passengers safely away from the curb while the bus approaches. Many stations also feature raised curbs for easier boarding.

**H** Platform areas are distinguished by a dark gray concrete pattern.

**I** Benches at stations provide a place to sit.

**J** Most stations have bike parking.

Some stations have pedestrian-scale light fixtures to provide a safe, well-lit environment.

At some stations, railings separate the platform from the sidewalk.

# Completed planning work (2019 – 2020)

- Extension to Union Depot in downtown St. Paul, evaluated and recommended in response to stakeholder requests
- Route B Line along Marshall, Snelling, Selby Avenues
- 33 preliminary B Line station locations identified
- Preliminary bus service plan

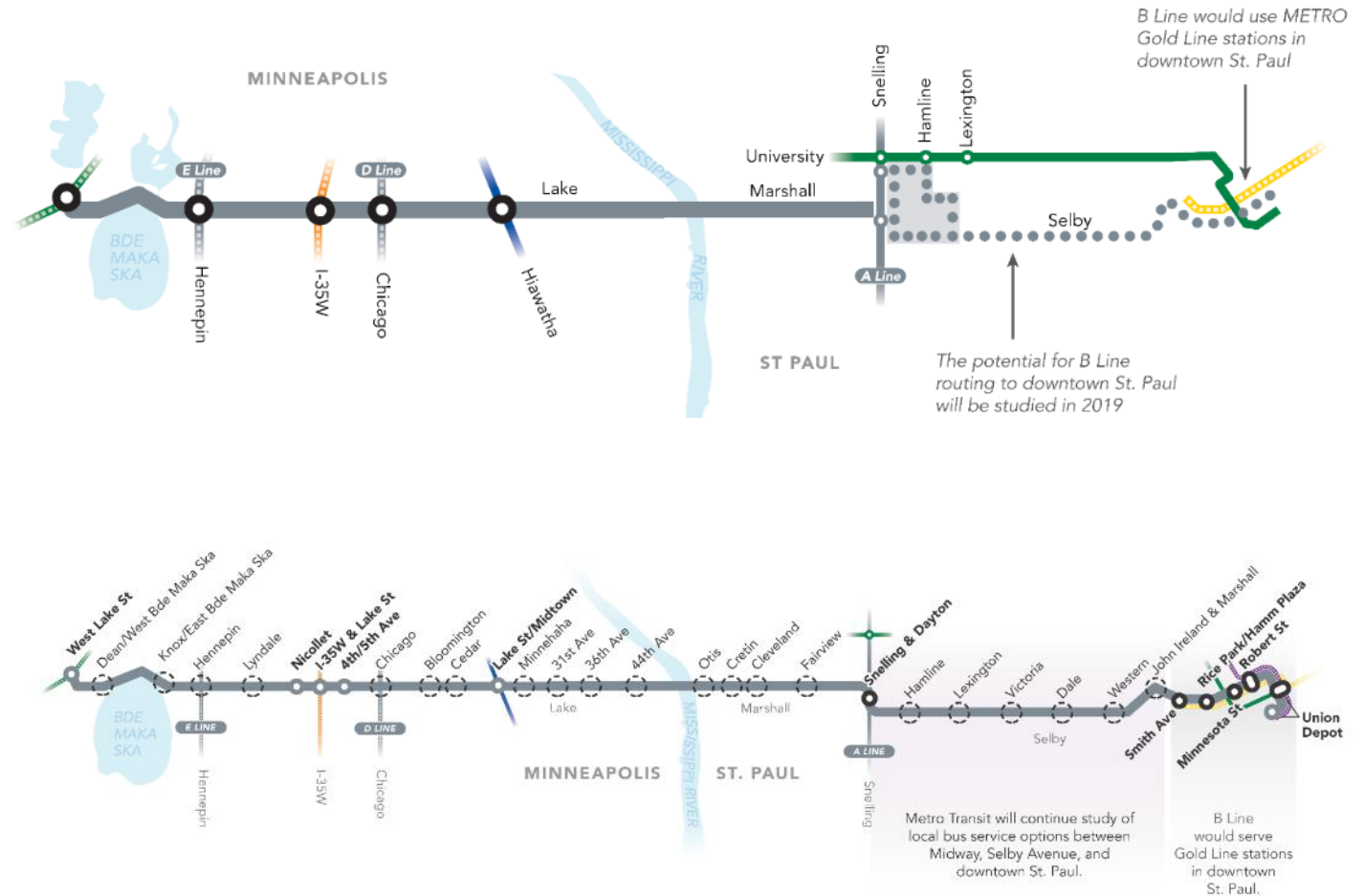

# Community engagement results

- Engagement goal: engagement and feedback on main planning questions
- Engagement activities:
  - open house meetings
  - bus stop pop-ups and ride-alongs
  - neighborhood/group meetings
  - office hours, business pop-ups, and doorknocking
  - community events
- Significant feedback relating to travel time, frequency, and reliability
- Large majority in favor of downtown St. Paul endpoint
- Mixed feedback regarding alignment
  - Majority of open house attendees favored alignment that remains south of I-94
  - Majority of feedback in Midway and Selby Avenue areas indicated preference for alignment directly serving Midway

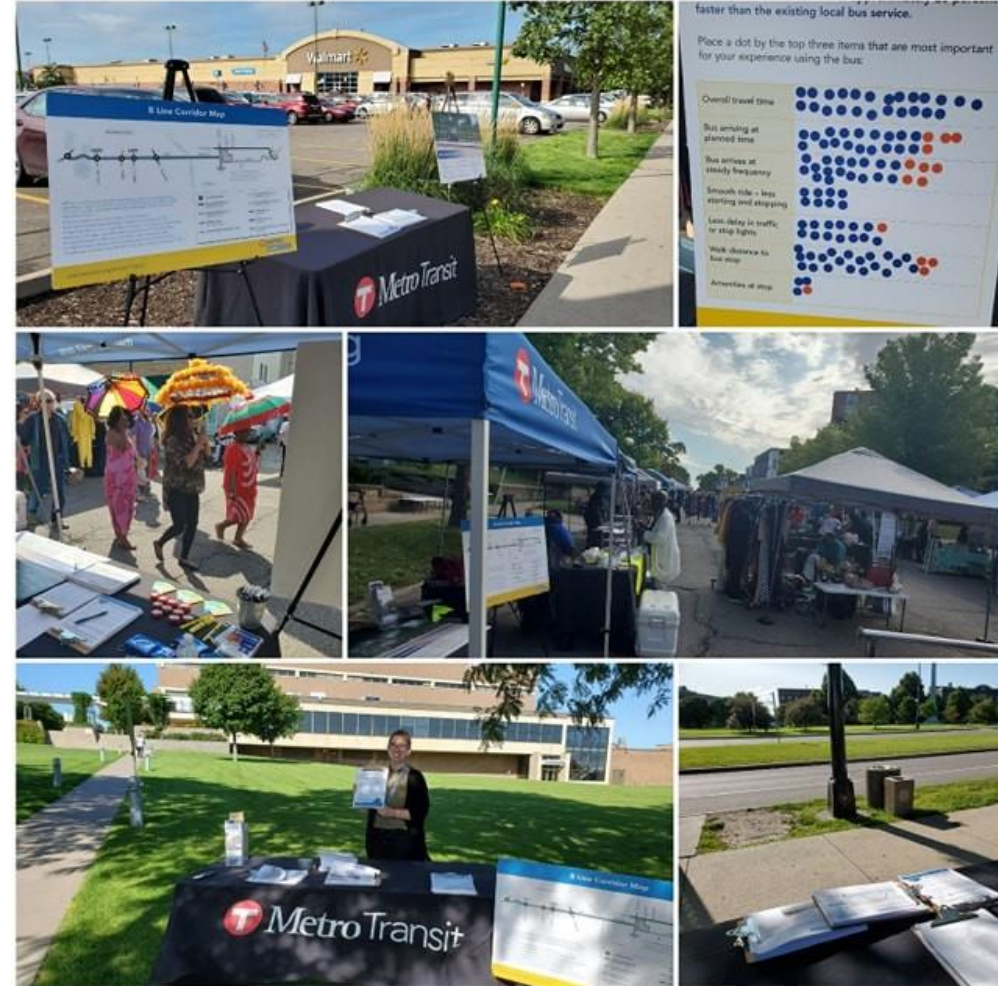

# Draft B Line Corridor Plan

- **Planned station locations: station intersections and location of platforms within each intersection**
- **Corridor Context:**
  - Refined bus service plan: local and limited-stop bus service within and along B Line corridor
  - Potential bus priority treatments to meet project speed and reliability goals

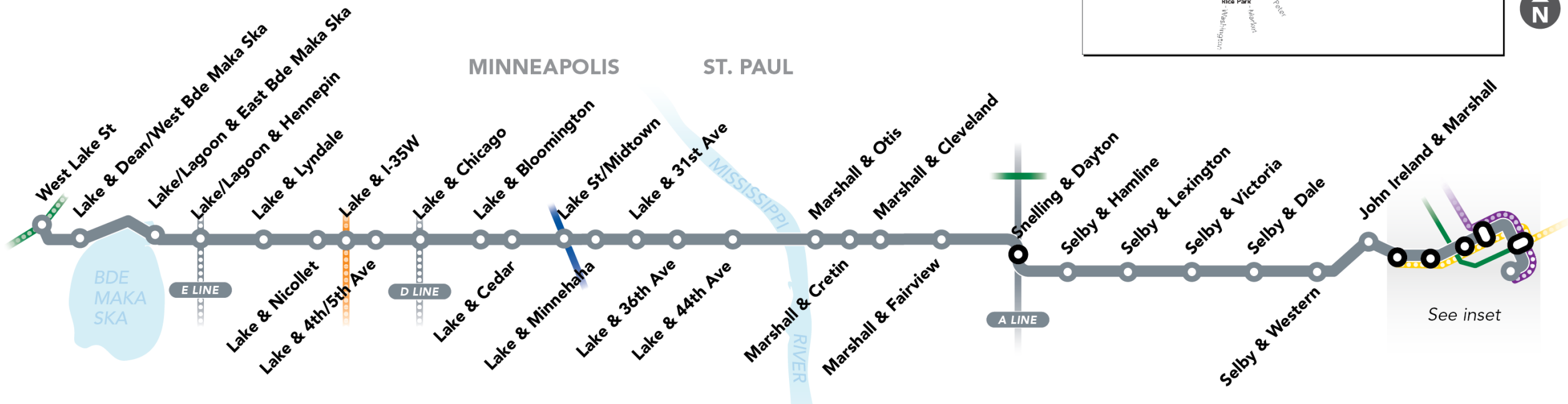
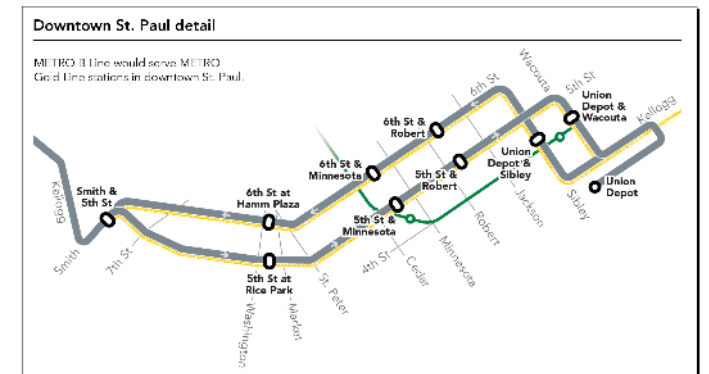

# Core element of Corridor Plan: Station and platform locations

- Proposed platform locations developed through site-specific review
- Excludes locations finalized as part of other projects
- Concept designs will continue to evolve through coordination and engineering

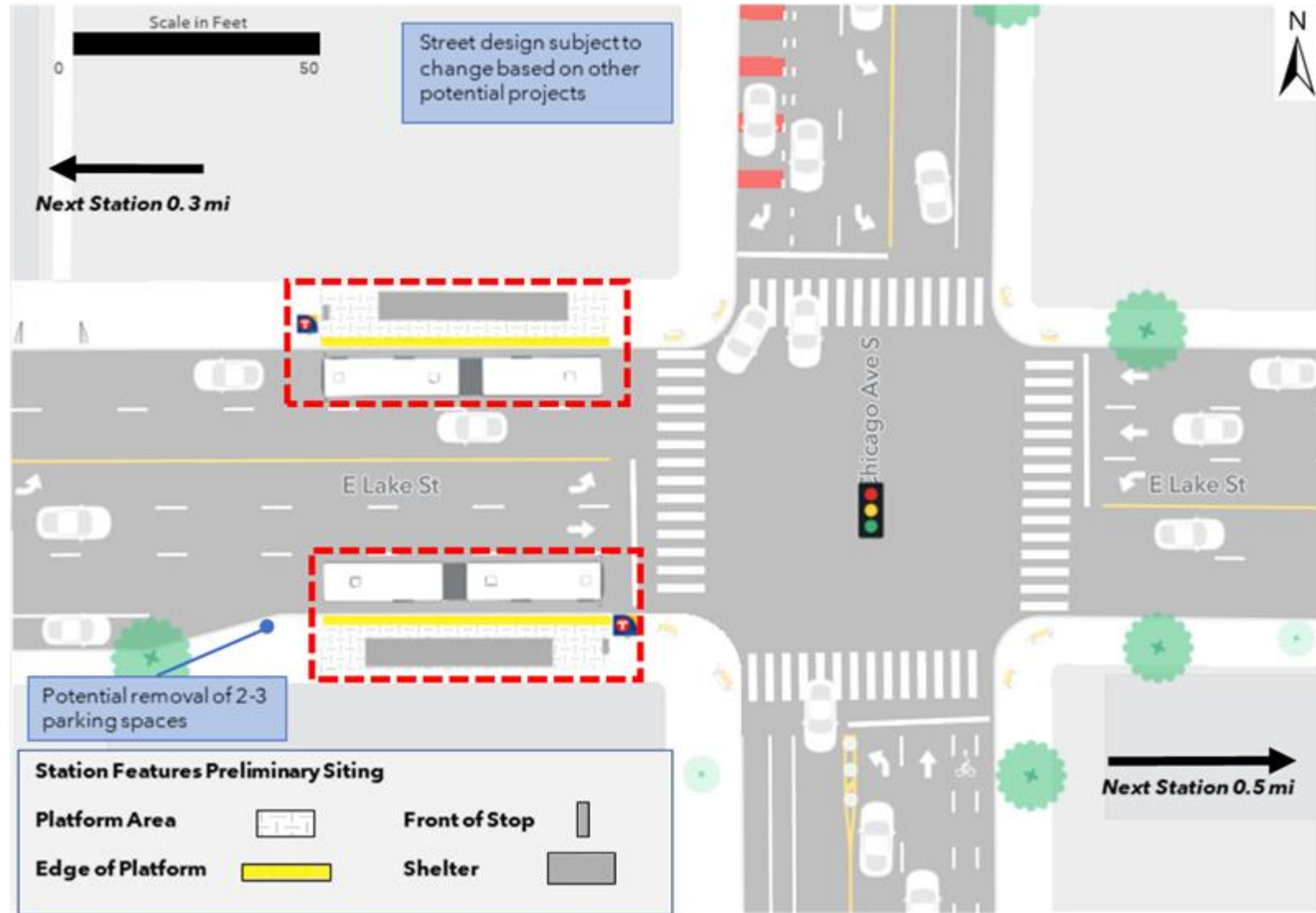



# Lake and Bloomington

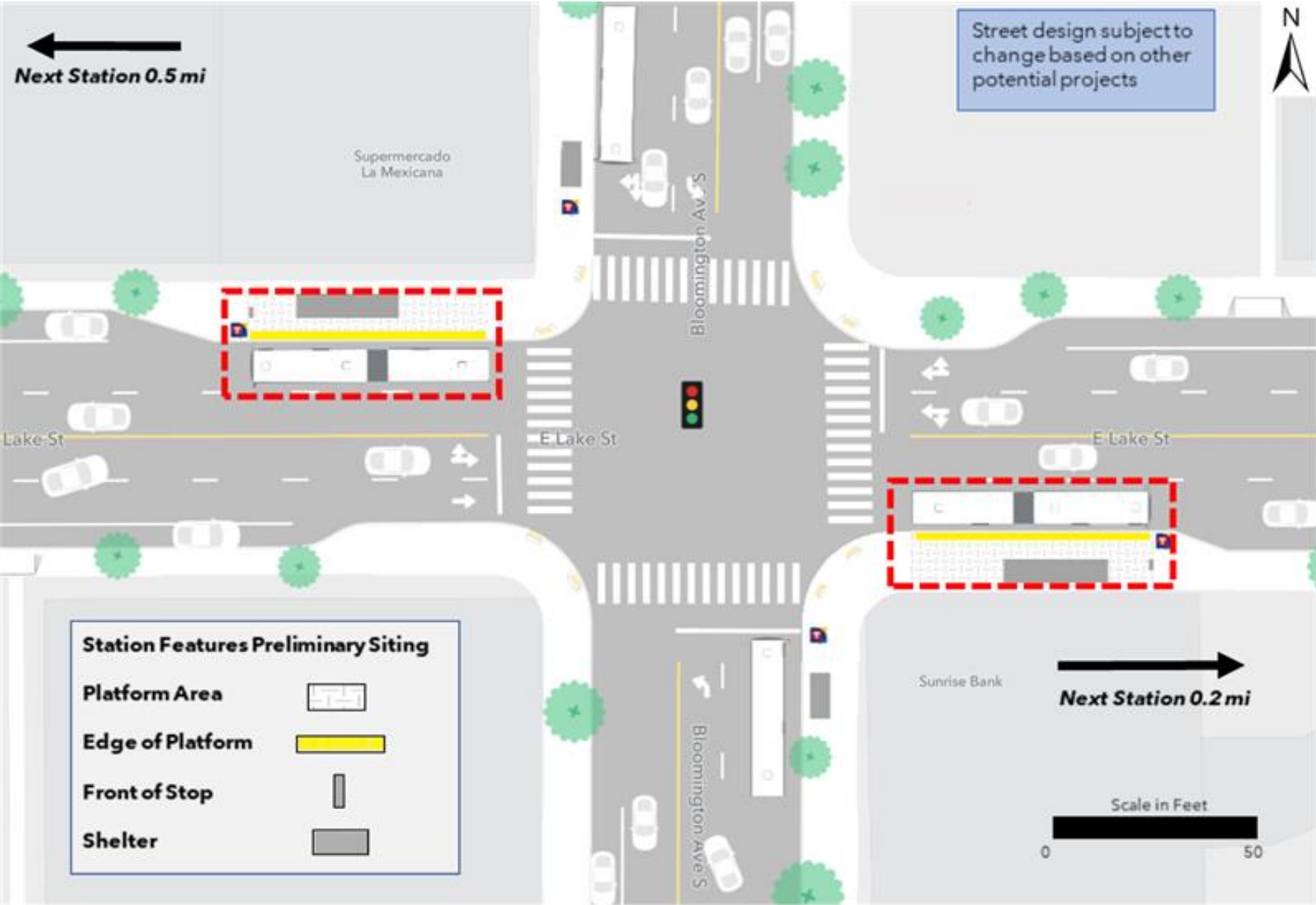

# Lake and Cedar

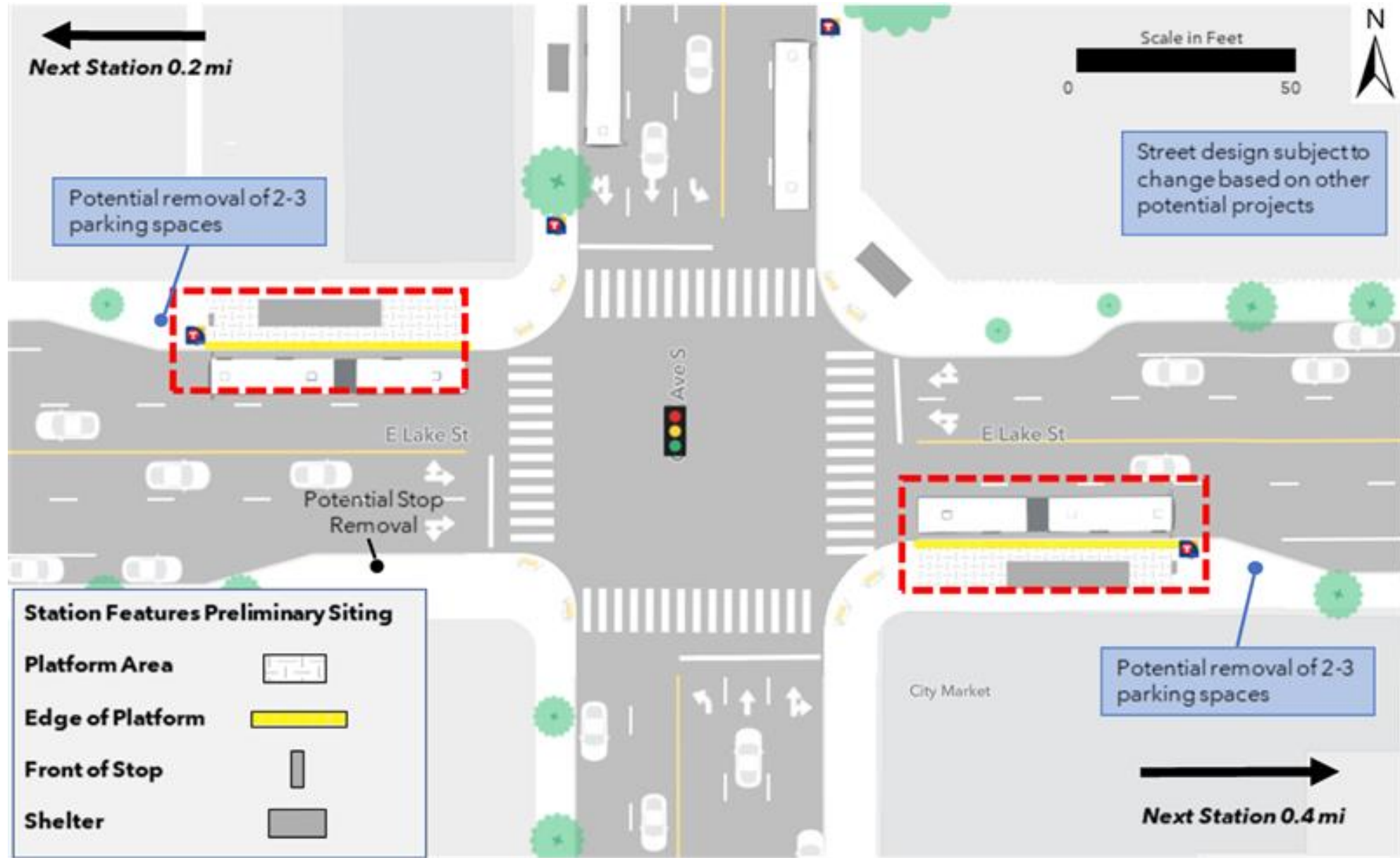

# Additional information: Concept bus service plan

- B Line service would run every 10 minutes, seven days a week during the day and most of the evening
- Local service on Route 21 would run every 30 minutes between Hennepin Avenue and Minnehaha Avenue
- Local service on new route (Route 60) would run every 30 minutes along Selby Avenue connecting to Midway area of St. Paul
- Concept service plans will be refined and further developed closer to B Line opening
- Route 53 service will be evaluated as the B Line approaches implementation



# How will people participate?

- Engagement will be primarily digital due to COVID-19
- People will be directed to the project website, where they can choose which elements of the plan to engage on
- Results will be collected, evaluated for Recommended corridor plan

## Faster transit is coming to the Route 21 Corridor

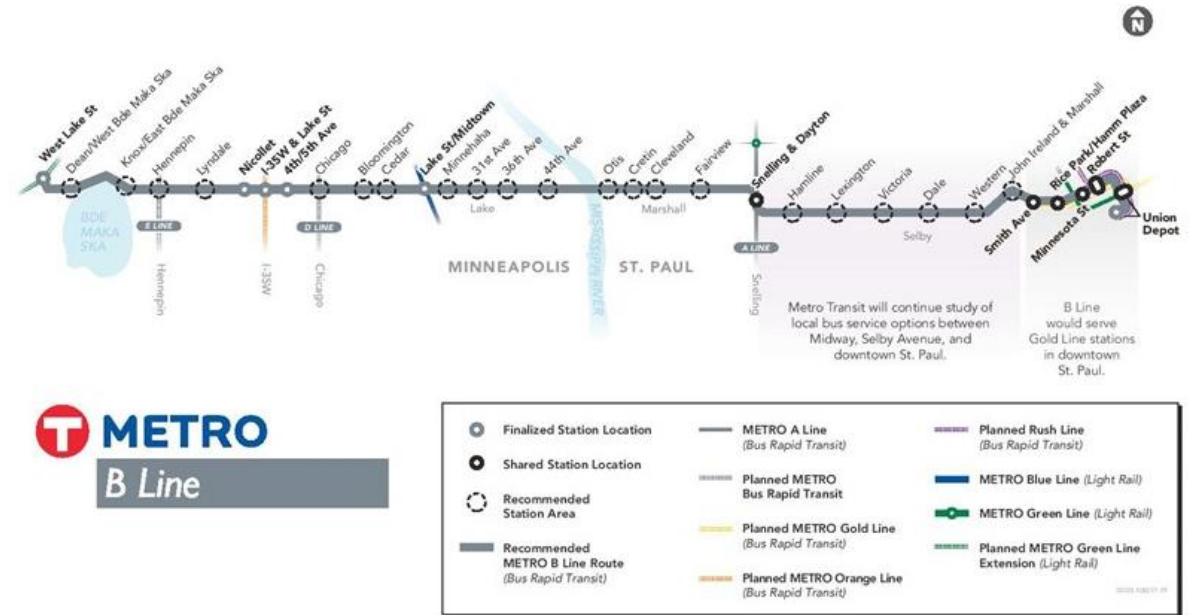

## What is the METRO B Line?

The METRO B Line is a planned Bus Rapid Transit (BRT) line that will provide faster and more reliable transit service in the Route 21 corridor along Lake Street and Marshall and Selby avenues.

BRT brings better amenities, faster service and a more comfortable ride.

- Faster, frequent service

# Where will outreach efforts be focused?

- Media communications:
  - Council communications: Social, Connect, Insights, Wire, Riders Club, Project Newsletter, Rider Alerts
  - Local media
  - Communications from neighborhood and community groups, project partners like Minneapolis, St. Paul, Hennepin/Ramsey county
- At-stop communications:
  - Flyers on non-transit items like light poles near all 21 stops
  - Limited in-person surveying



## Changes coming to Route 21 in 2024. Comment now.

El autobús de tránsito rápido llega a su vecindario

Baska xawliga ku socda ayaa imanaya xaafadaada

Tsheb npav khiav ceev los ze ntawm koj lub zos

[METROTRANSIT.ORG/B-LINE-PROJECT](https://metrotransit.org/b-line-project)



## Next Steps and project schedule

- Distribute Draft Corridor Plan and seek feedback
- Recommended Corridor Plan: May 2021
- Final Corridor Plan: September 2021
- Engineering: Mid-2021 – Late 2022
- Construction: 2023 – 2024



**Cody Olson, Community Outreach Coordinator**  
[cody.olson@metrotransit.org](mailto:cody.olson@metrotransit.org)

[www.metrotransit.org/b-line-project](http://www.metrotransit.org/b-line-project)