

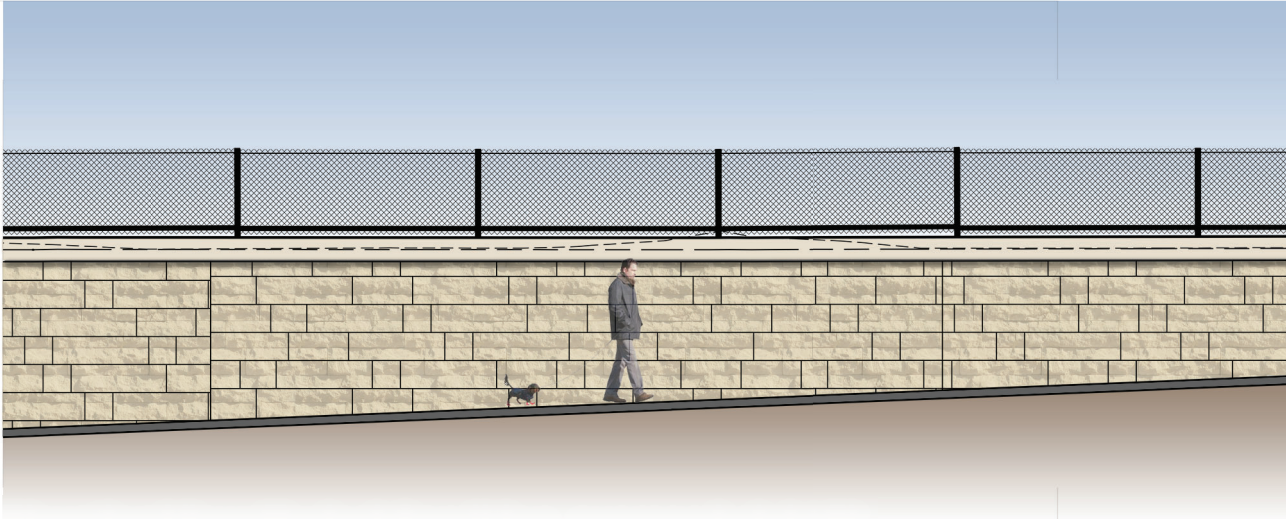

Limestone formliner texture with black vinyl clad chain link fence



Limestone texture at ABI



Elevation View: Typical Condition, average height 7'

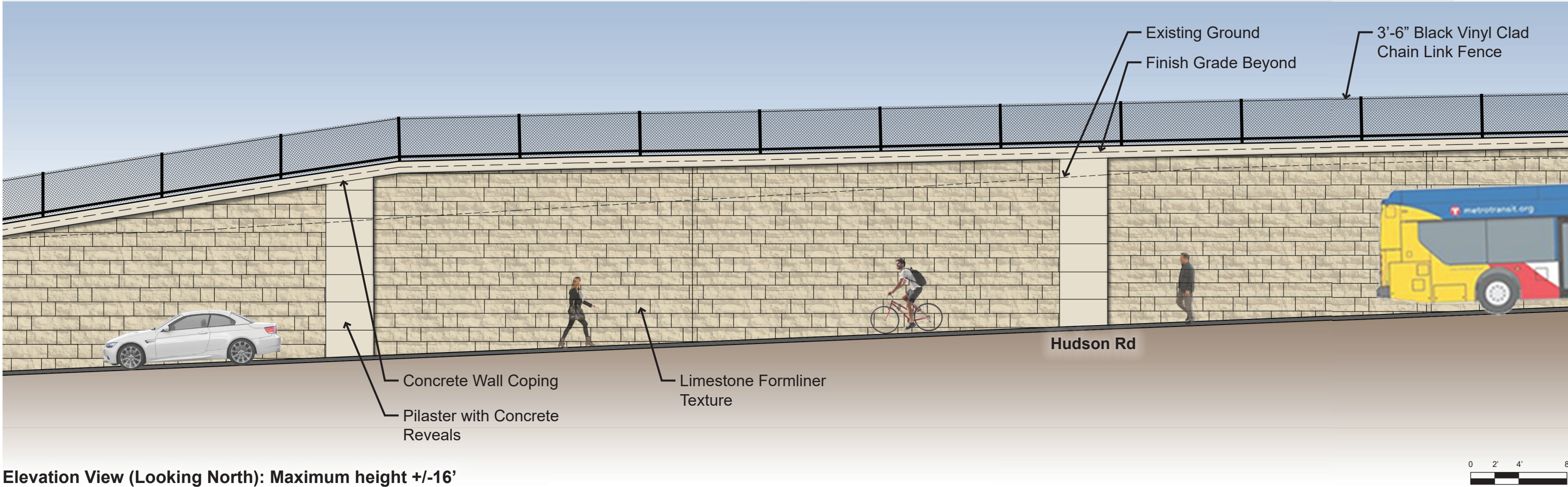

DRAFT - WORK IN PROCESS





Limestone Formliner Texture



Concrete with Reveals

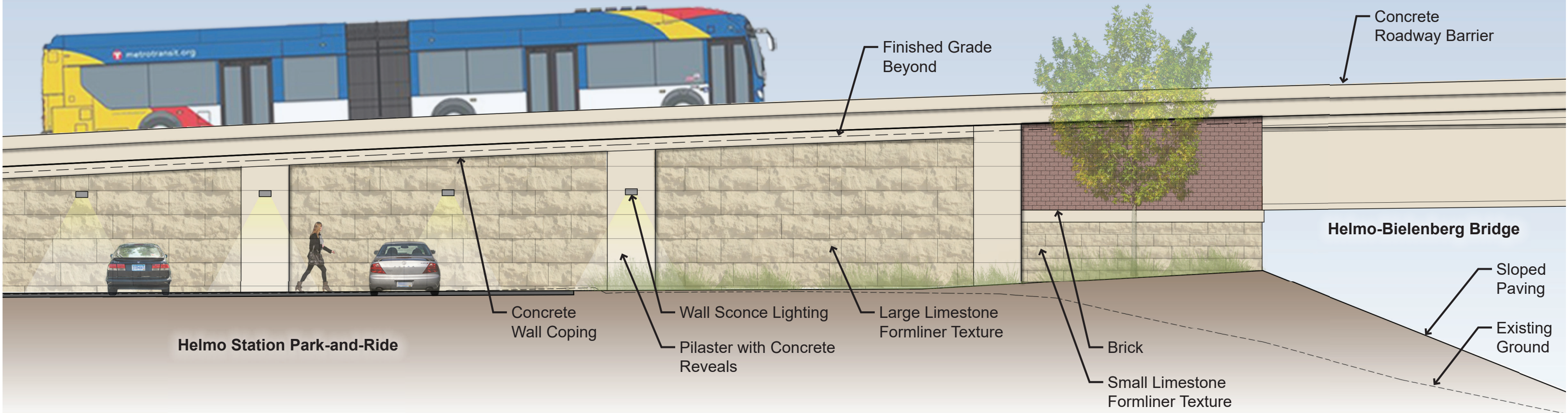

Elevation View (Looking East)



DRAFT - WORK IN PROCESS



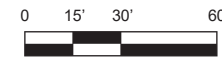
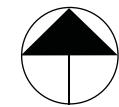
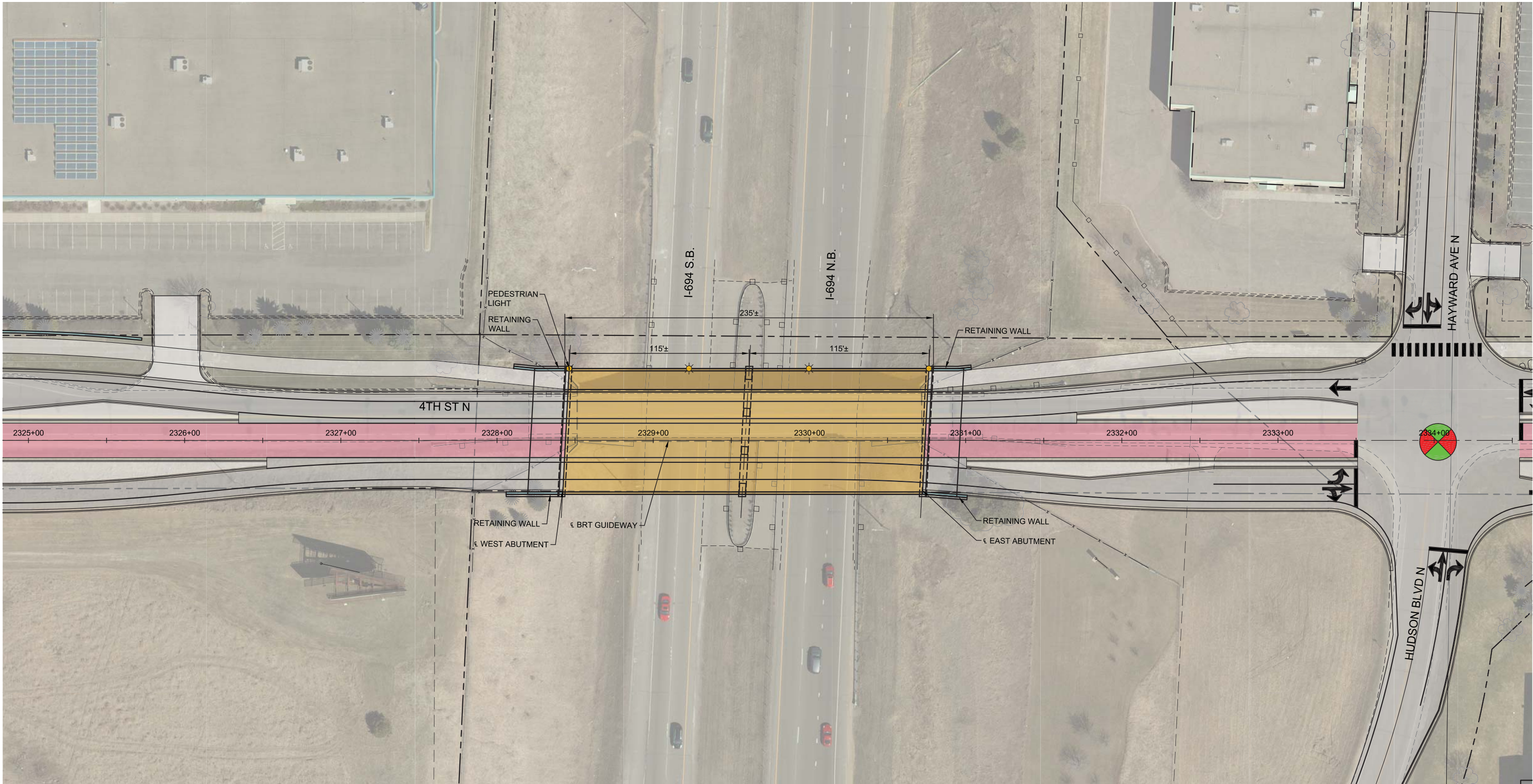

DRAFT - WORK IN PROCESS



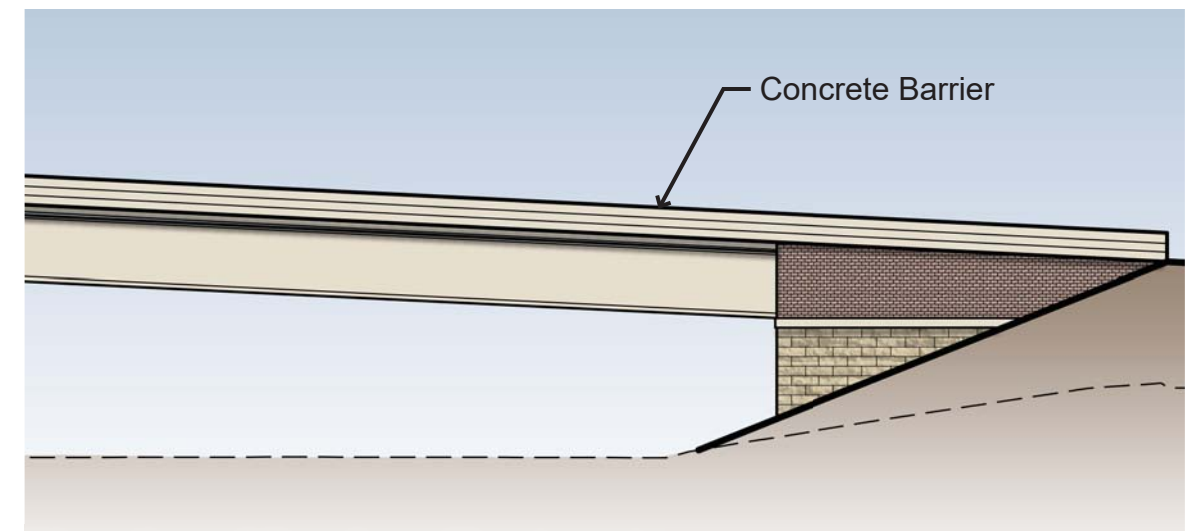

Elevation of Roadway Treatment

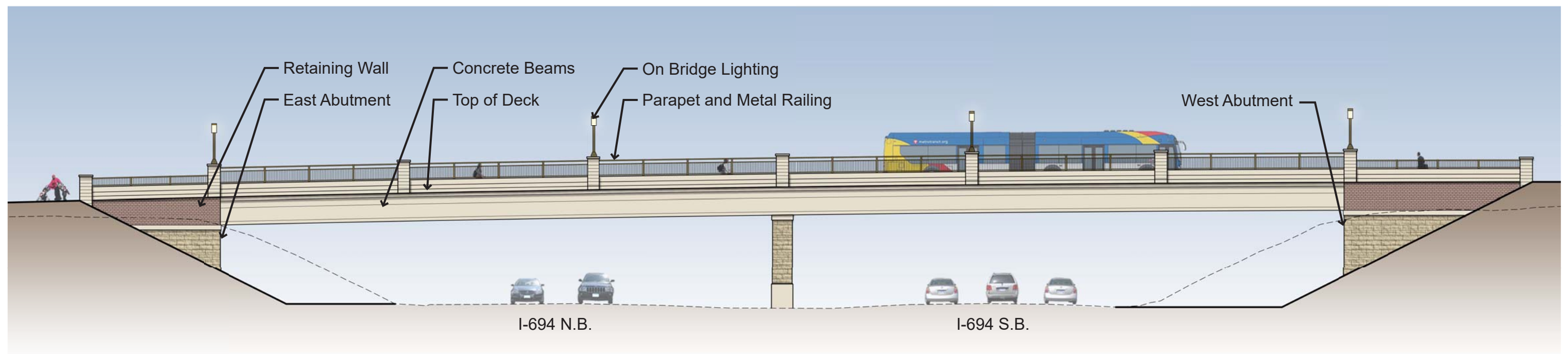

Elevation of Pedestrian Facility Treatment

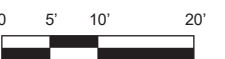

DRAFT - WORK IN PROCESS



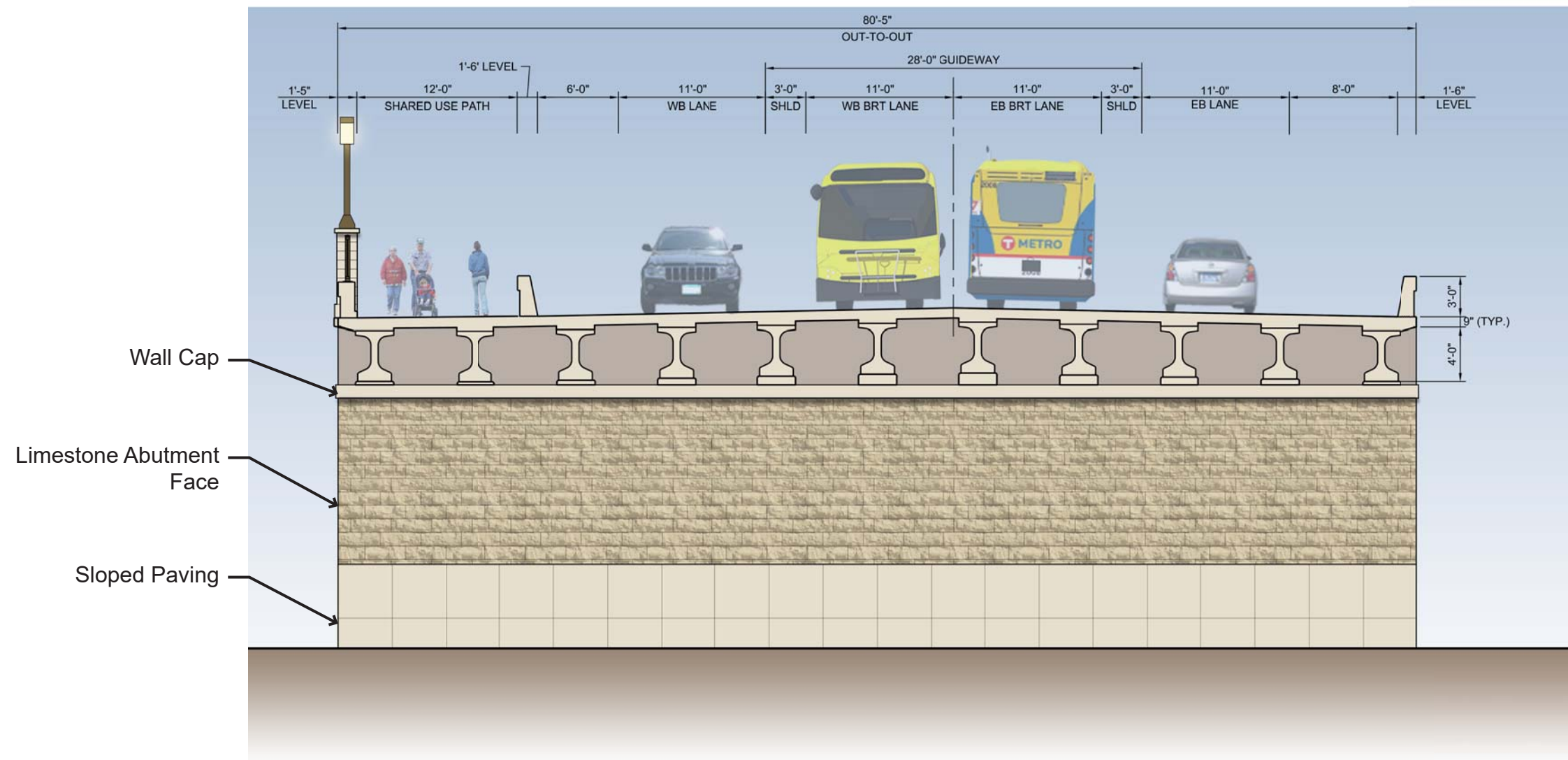

East Abutment

DRAFT - WORK IN PROCESS



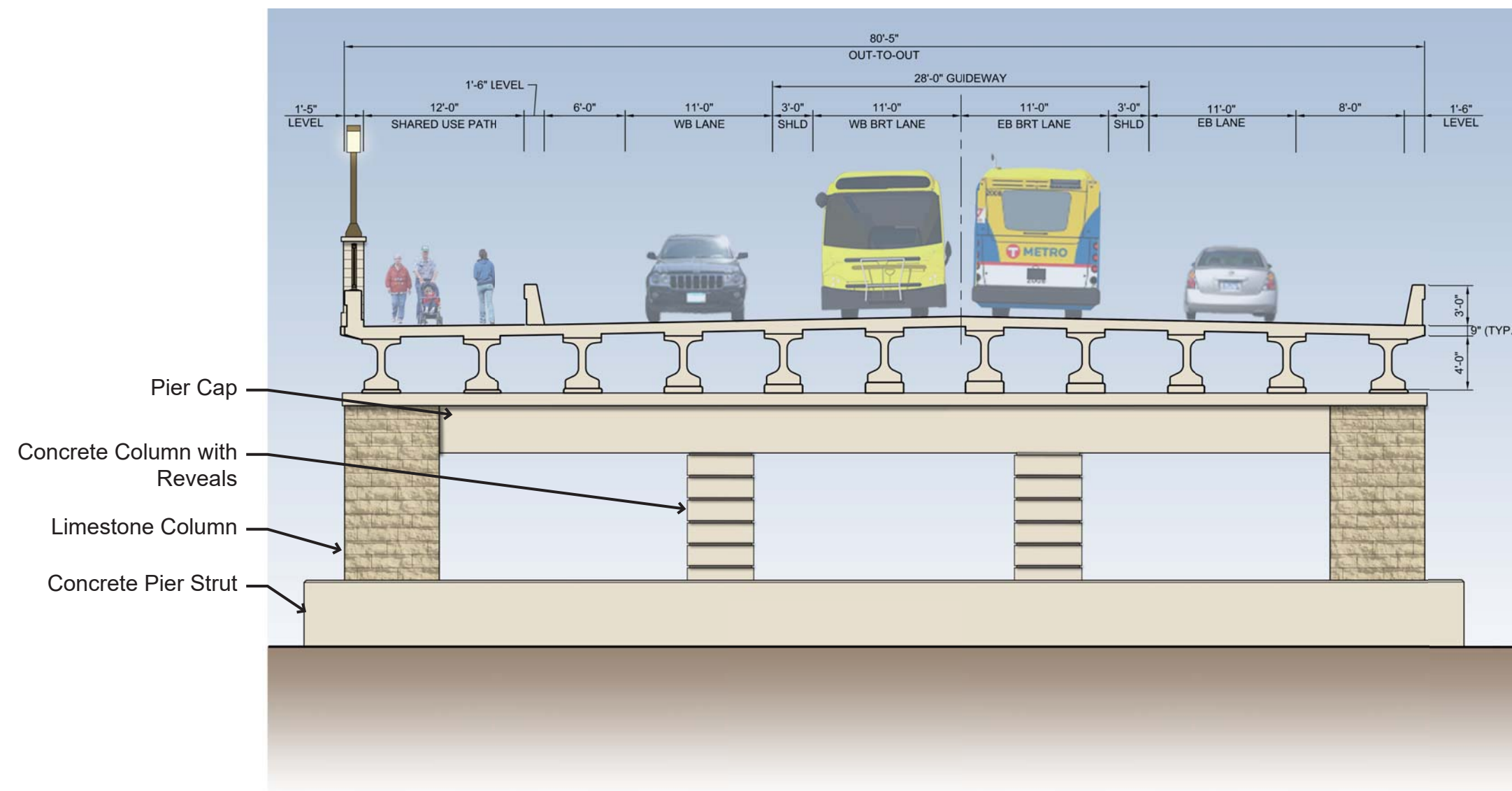

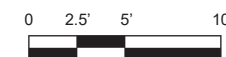

Pier Elevation Looking East



DRAFT - WORK IN PROCESS

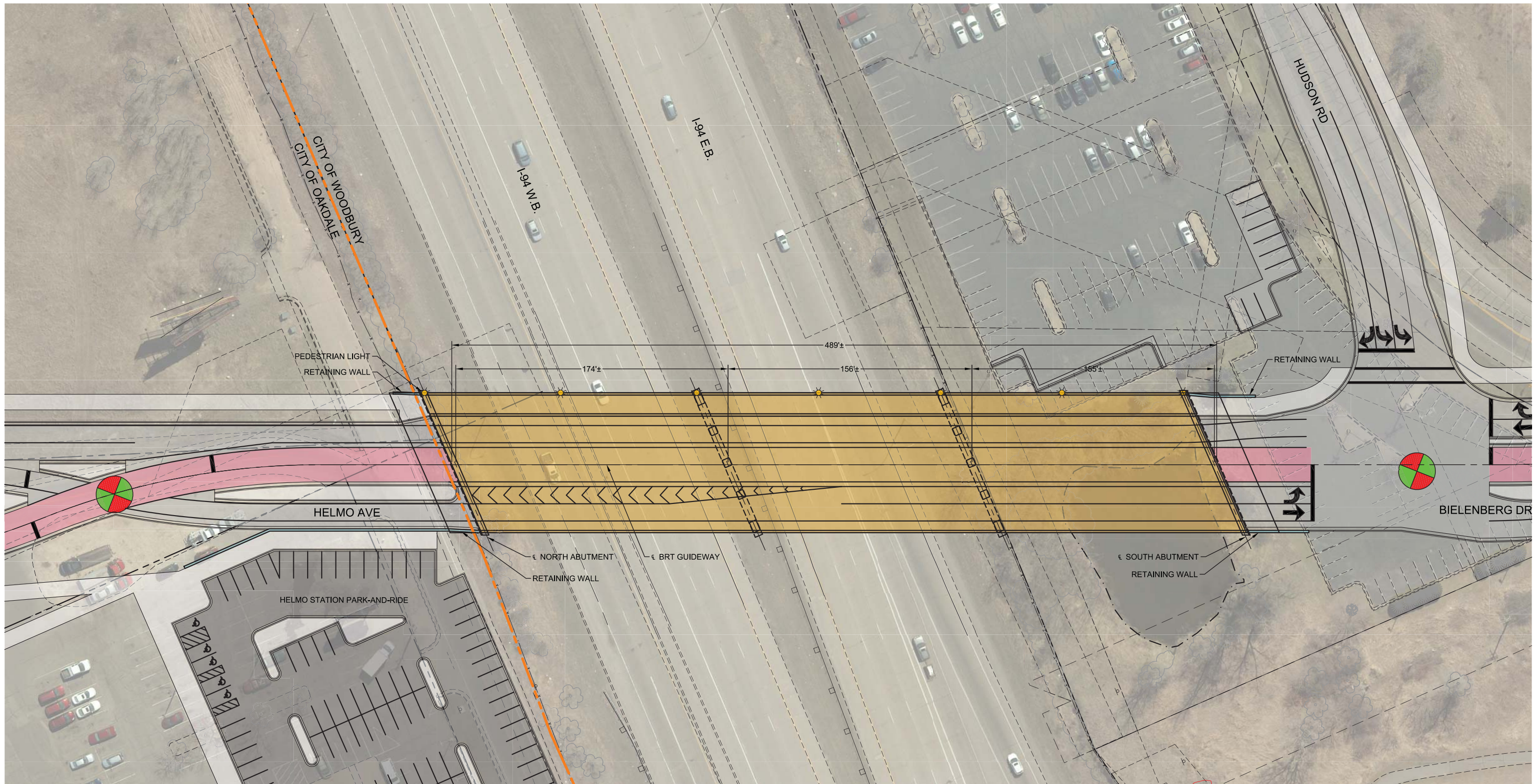





  
 DRAFT - WORK IN PROCESS

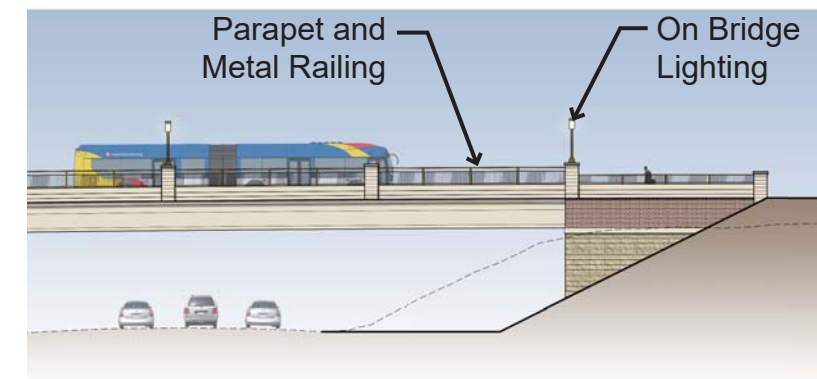

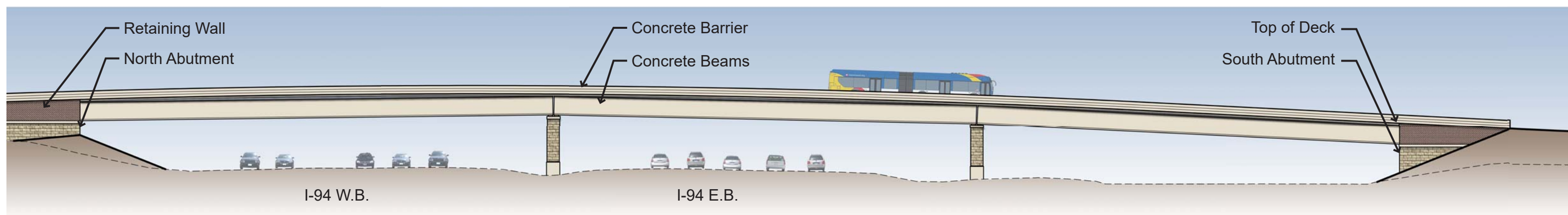

**Elevation of Pedestrian Facility Treatment**



**Elevation of Roadway Treatment**

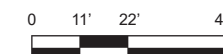

**DRAFT - WORK IN PROCESS**



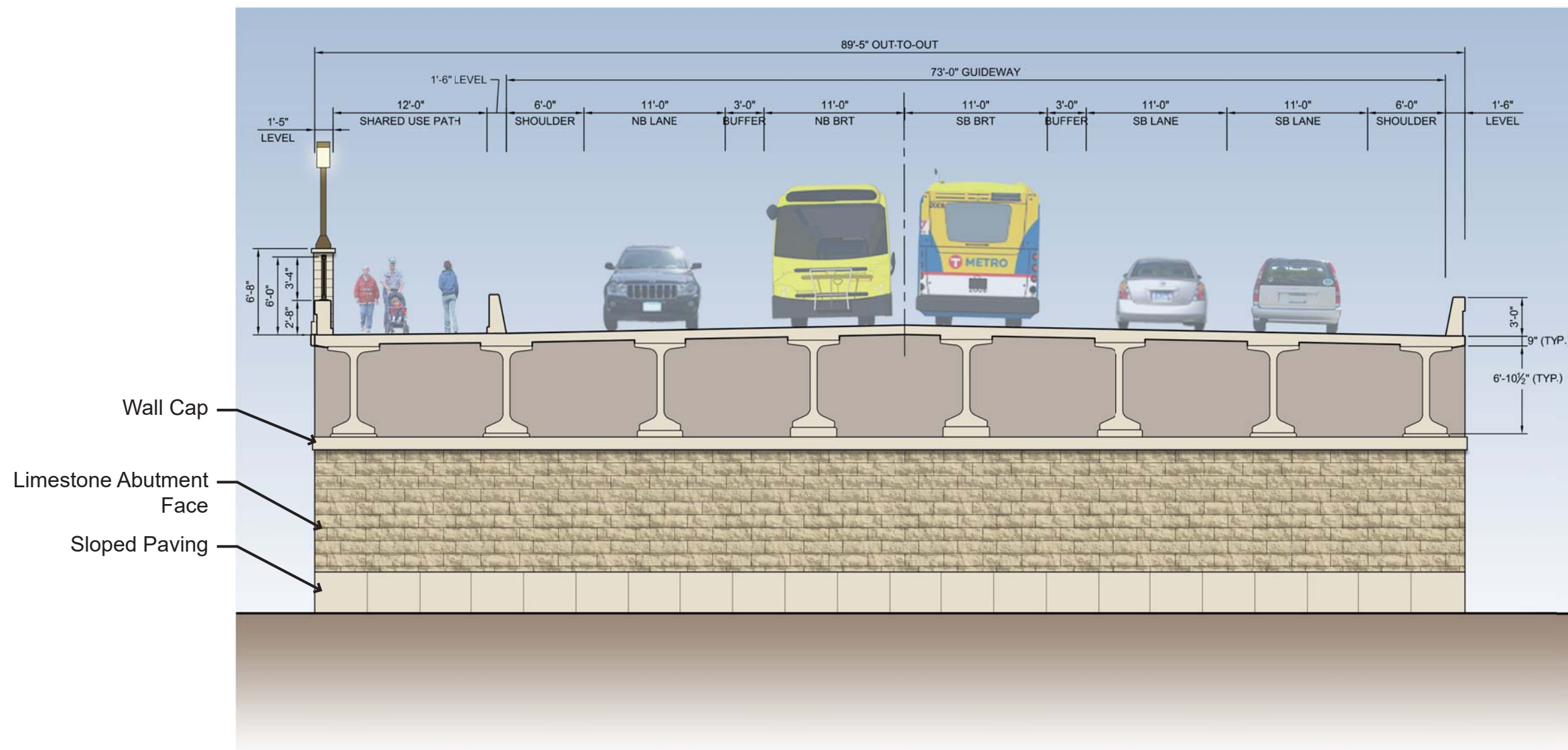

South Abutment



DRAFT - WORK IN PROCESS



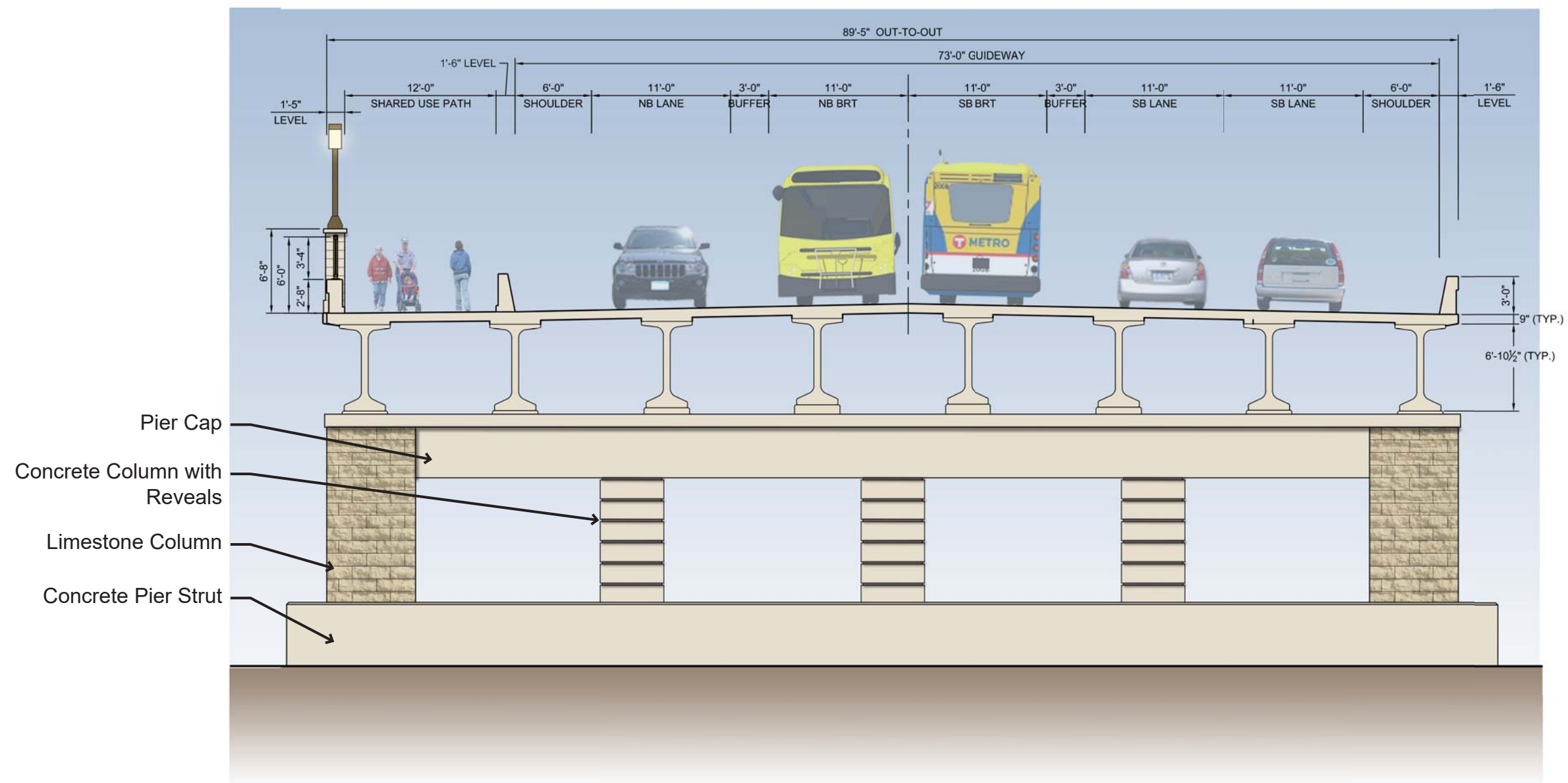

Pier 2 Elevation Looking South



DRAFT - WORK IN PROCESS





Limestone formliner texture



Limestone texture at Woodbury City Hall



Valley Creek Rd & I-494 bridge:  
Ornamental Railing

**Wall at Woodbury Theatre Station (Wall 475)**

---



Sheet pile wall with post and picket railing to match existing small block retaining wall

**Wall at Tamarack Hills (Wall 470)**

DRAFT - WORK IN PROCESS





Limestone formliner texture

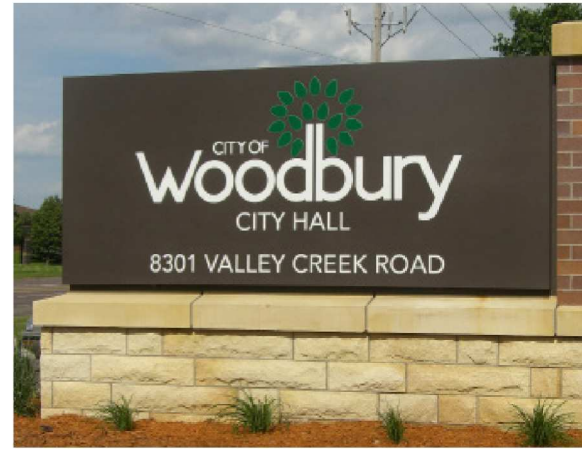

Limestone texture at Woodbury City Hall



Valley Creek Rd & I-494 bridge:  
Ornamental Railing

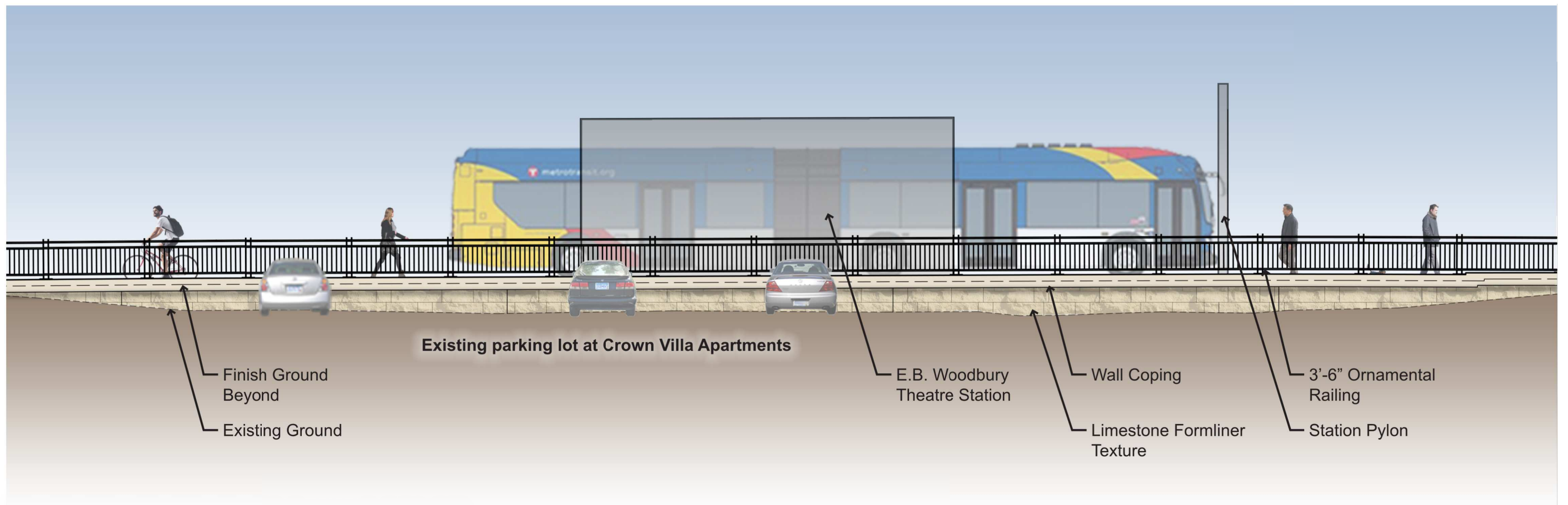

Elevation View (Looking South): Average height +/-3'



DRAFT - WORK IN PROCESS