



METRO F Line – Draft Corridor Plan

Virtual Open House | November 15, 2022

F Line project staff

metrotransit.org/f-line-project



Nasser Mussa
F Line Community
Outreach Coordinator



Jake Knight
F Line Planning Lead



Frank Alarcon
F Line Project Manager



Yumi Nagaoka
Supervisor, Public
Involvement

Meeting agenda

metrotransit.org/f-line-project



- Welcome + meeting logistics (6:30-6:35)
- Presentation (6:35 – 7:00)
- Questions and answers (7:00 – 8:00)
- This meeting is being recorded and will be available on the project website

Meeting logistics

- Closed captioning available
- Technical issues?
 - Check device settings
 - Email Fline@metrotransit.org
- Attendees' microphones and video are disabled by default

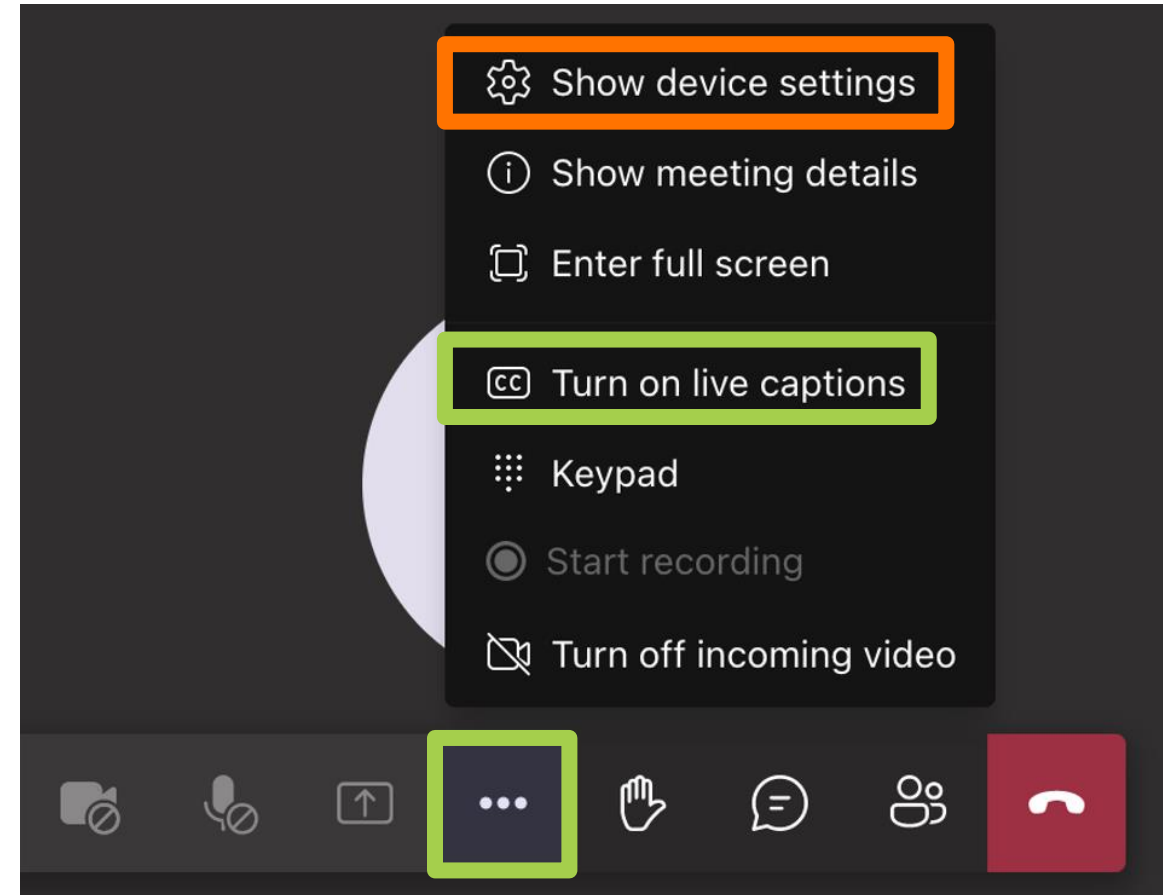

Q&A instructions and process

- Please submit questions and comments using the [chat](#)
 - As needed, use the [“Raise hand”](#) feature to verbally ask a question
 - We will then enable your microphone so you can unmute
- Please keep questions relevant to this project
- We will address as many submitted questions as possible
 - Responses organized to prioritize hearing from as many people as possible
 - Written responses to questions will be provided after the meeting

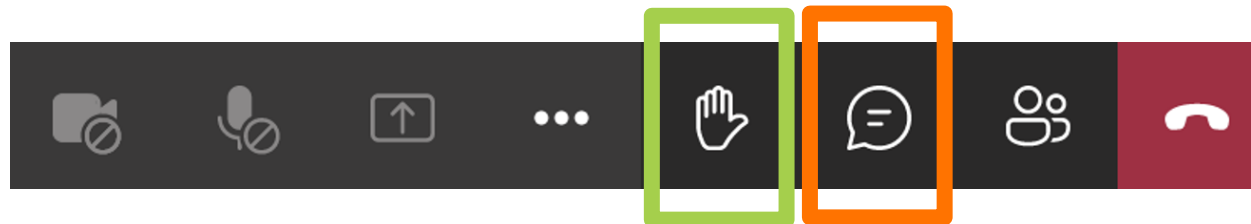

METRO F Line Bus Rapid Transit

- Fast, frequent, all-day service
- 13-mile corridor from Northtown Transit Center to downtown Minneapolis
- Substantial upgrade to Route 10, one of the region's highest-ridership bus routes
- 32 stations with enhanced features
- Targeted opening in 2026



metrotransit.org/f-line-project



Potential Local Service –
Preliminary
October 2022

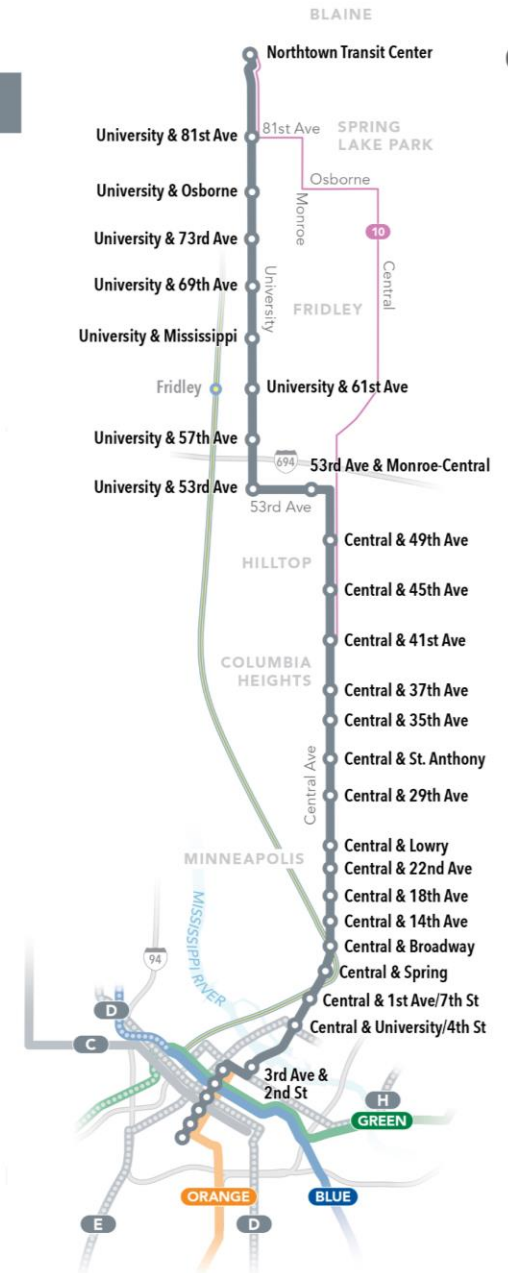
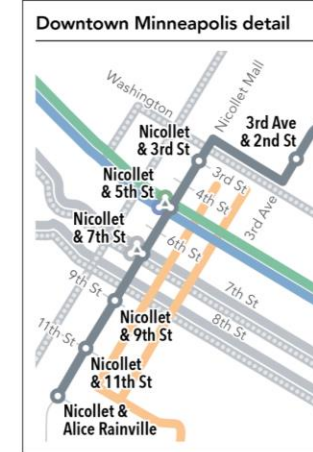
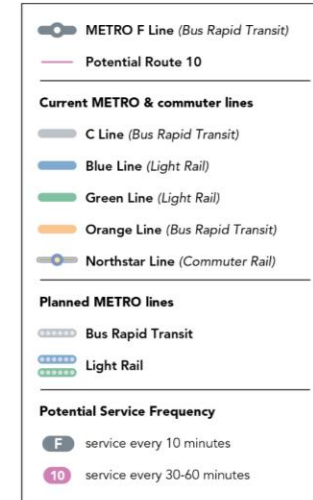

Project schedule

- Currently seeking **community input** to establish **station locations** prior to the Engineering phase
- Community engagement will continue through the Engineering and Construction phases

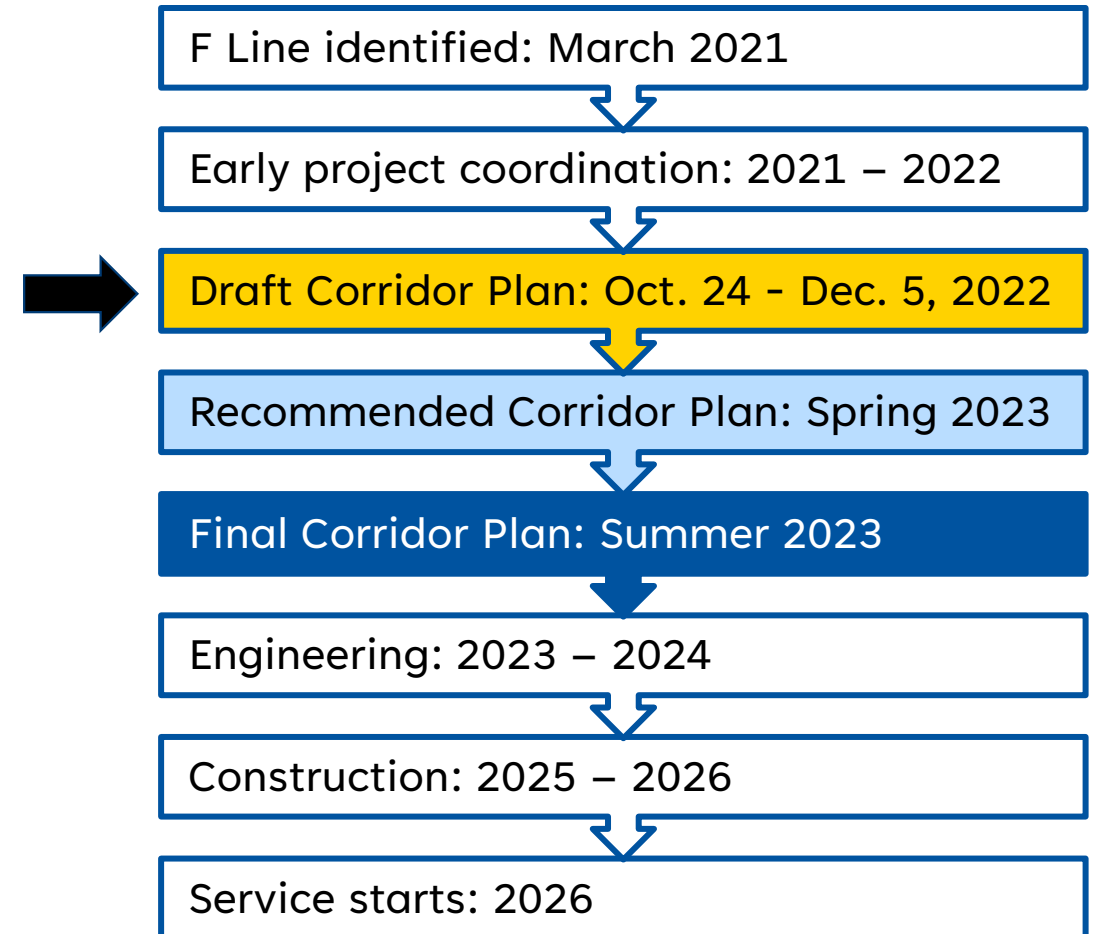

Need for improved transit in the corridor

- Provide faster, more reliable, more attractive bus service
- Improve the transit experience at stops and on vehicles

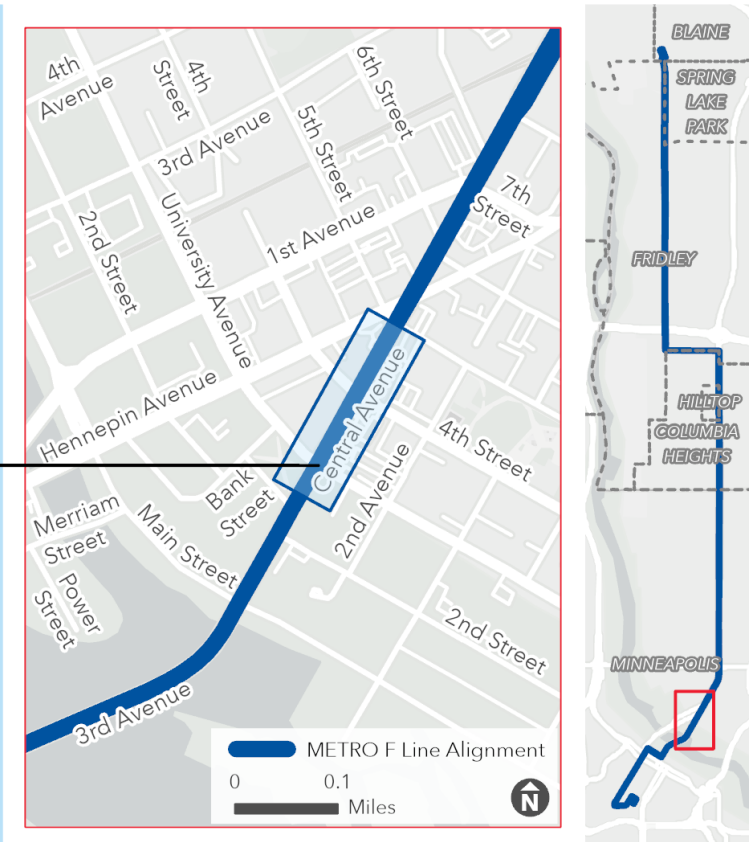
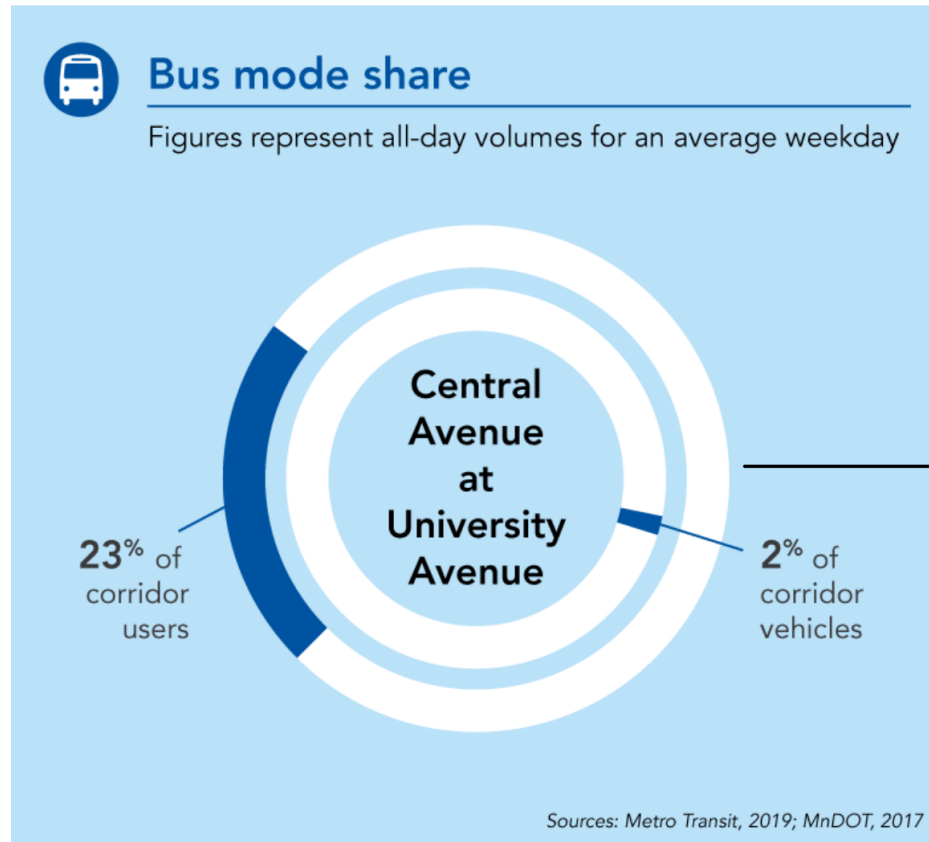

Need for improved transit in the corridor (cont.)

- Improve transit access in NE Minneapolis and northern suburbs
 - Connection to METRO **network** of LRT and BRT
- Who rides Route 10? (2021)
 - Half of riders are people of color
 - 80% report household income less than \$60,000 (half report less than \$35,000)
 - 20% identify as having a disability
 - 36% of trips for commuting to work (18% for “9 to 5”)



What is arterial bus rapid transit, or BRT?



Arterial bus rapid transit (BRT)

A package of transit enhancements that adds up to a **faster trip** and **improved experience**

Learn more at
metrotransit.org/brt



Designed to be faster, more reliable, and easy to use

metrotransit.org/brt



2-3 stations per
mile for faster
stops

High-tech, high-
amenity, secure
stations

Pre-boarding fare
payment for
faster stops

Higher-capacity
buses & boarding
through all doors

Bus priority
signals & lanes

Faster, frequent,
all-day service



What will F Line stations look like?



A **Pylon markers** help riders identify stations from a distance.

B **Real-time NexTrip signs** provide bus information, and on-demand **annunciators** speak this information for people with low vision.

C **Shelters** provide weather protection and feature push-button, on-demand **heaters** and shelter **lighting**. Shelter sizes will vary based on customer demand (small shown here).

D **Ticket machines** and **fare card readers** collect all payment before customers board the bus.

E **Emergency telephones** provide a direct connection to Metro Transit police. Stations also feature **security cameras**.

F Stations feature **trash and recycling** containers.

G Platform edges are marked with a cast-iron **textured warning strip** to keep passengers safely away from the curb while the bus approaches. Many stations also feature **raised curbs** for easier boarding.

H **Platform areas** are distinguished by a dark gray concrete pattern.

I **Benches** at stations provide a place to sit.

J Most stations have **bike parking**.

At some stations, **railings** separate the platform from the sidewalk.

Some stations have pedestrian-scale **light fixtures** to provide a safe, well-lit environment.

A network of twelve BRT lines planned by 2030

- Red Line: 2013
- A Line (Snelling): 2016
- C Line (Penn): 2019
- Orange Line: 2021
- D Line (Chicago/Fremont – Route 5): 2022
- B Line (Lake/Selby – Route 21): 2024
- E Line (Hennepin/France – Route 6): 2025
- Gold Line: 2025
- F Line (Central Avenue – Route 10): 2026
- Purple Line: 2026
- G Line (Rice/Robert – Routes 62/68): 2027
- H Line (Como/Maryland – Route 3): 2028

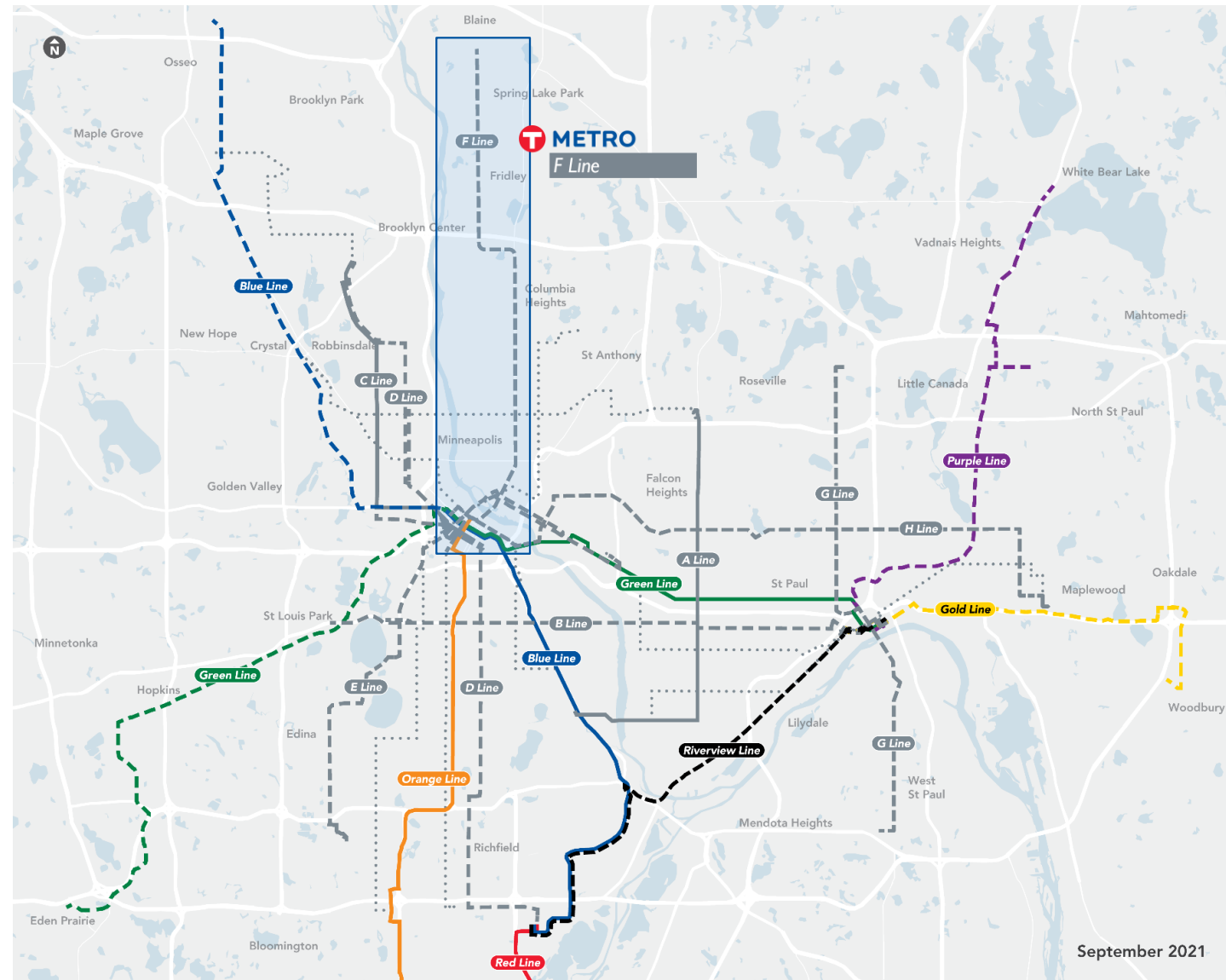

Current METRO network

- A Line
- C Line
- Blue Line
- Green Line
- Orange Line
- Red Line

Planned METRO network

- - - Planned BRT
- ... Additional candidates for BRT between 2030 and 2040
- Gold Line
- Purple Line
- Green Line Extension
- Blue Line Extension
- Riverview Line

How was the F Line selected?

- Identified through Network Next (2020-2021)
- Process based on Metropolitan Council **policy**, shaped by **performance data** and **community input**
 - Advance **equity** and reduce regional racial disparities
 - Build on success to grow **ridership**
 - Design a **network** that supports a transit-oriented lifestyle
 - Ensure the **long-term sustainable** growth of the bus network
- Prioritized for near-term implementation through community surveys

Metro Transit ridership during the pandemic

- Steady growth on all modes
 - Sept. 2022 highest monthly ridership since the pandemic
- Local bus: 67% of pre-COVID
- Light rail: 50%
- BRT: Almost even
- All-day, all-purpose trips

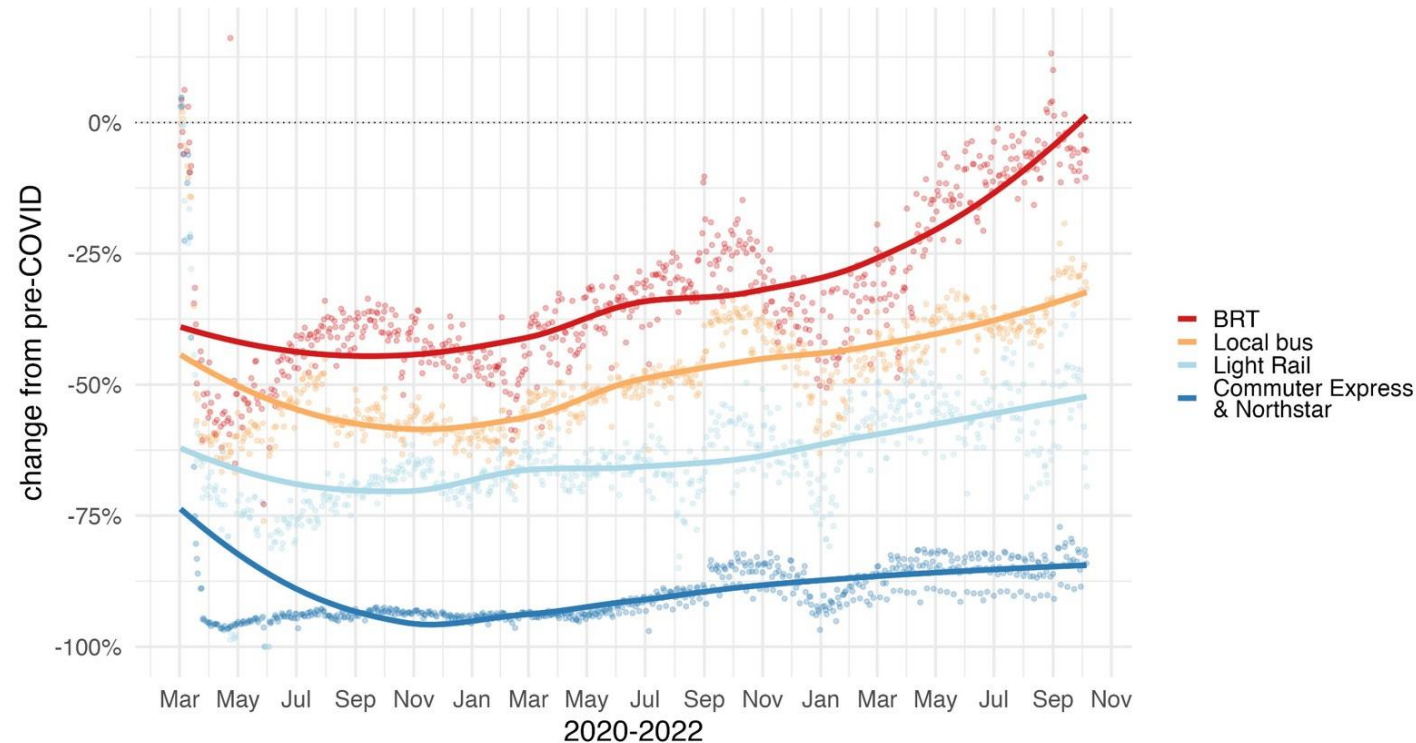

Project partners



Coordination with other projects

- Coordinating design with several projects from MnDOT, county and city partners
- MnDOT: Hwy 47 and Hwy 65 Planning and Environmental Linkages (PEL) Study
 - Evaluating broader multimodal alternatives to improve safety and mobility
 - Higher-level concepts, narrowing options
 - Timing of project outcomes uncertain
 - Close collaboration to ensure compatibility

Learn more about MnDOT's PEL Study
talk.dot.state.mn.us/hwy-47-hwy-65-study



F Line

MnDOT PEL
Study Area

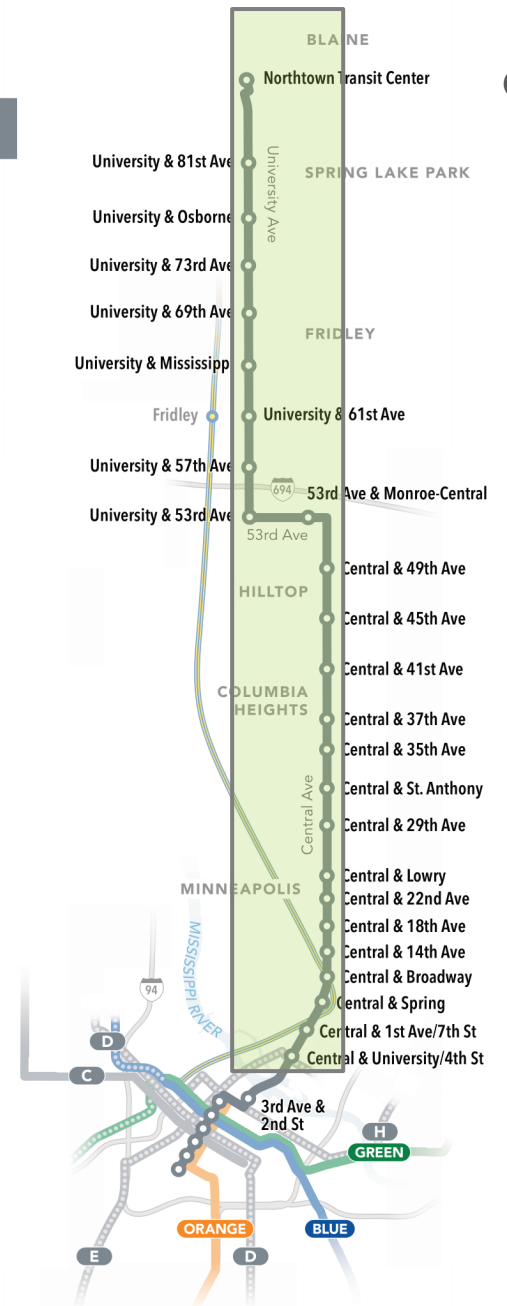
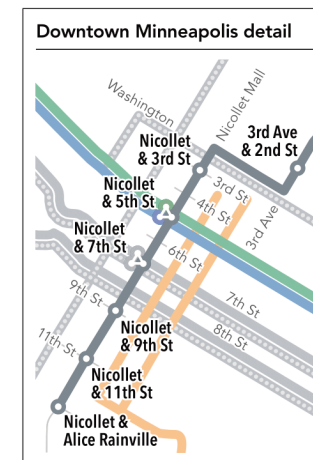
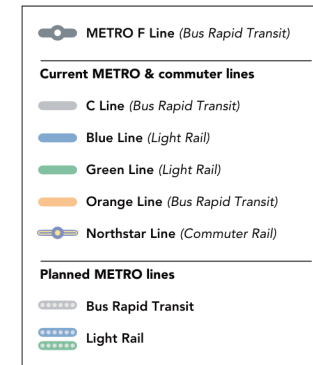

Help us plan station locations

25 built by the project
7 previously selected (small upgrades)
32 stations total



Station location considerations

- Spacing between stations
- Existing ridership
- Connecting transit service
- Community input
- Land use and access to destinations
- Street design and available right-of-way

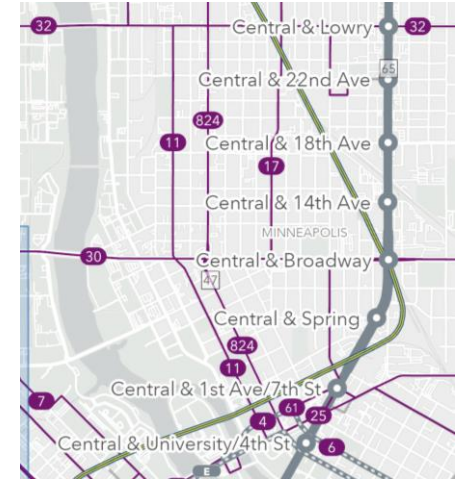
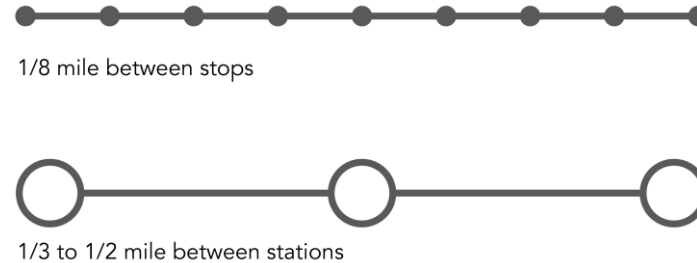

Station locations (north)

- 1 station proposed in Blaine
 - Northtown Transit Center
Station previously selected
- 2 in Spring Lake Park*
- 9 in Fridley*
- 2 in Hilltop*
- 6 in Columbia Heights*

*in or on the border of



Station locations (south)

- 19 stations proposed in Minneapolis*
 - 6 stations on Nicollet Mall previously selected

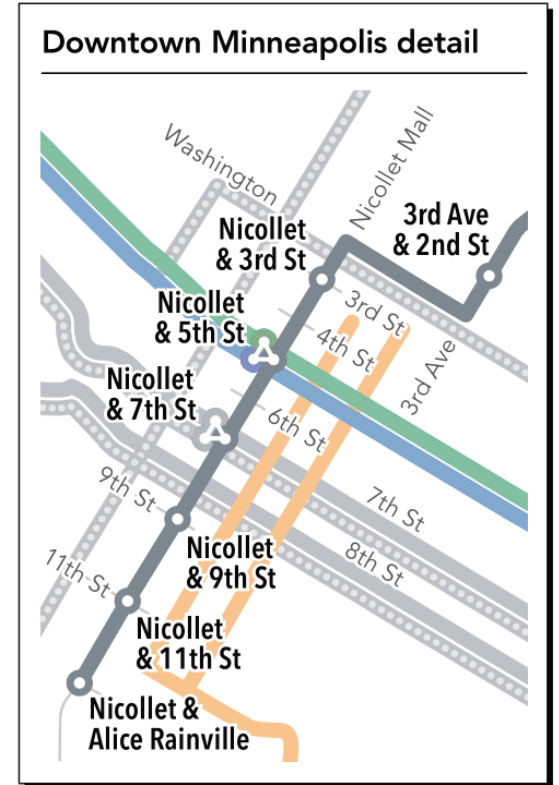
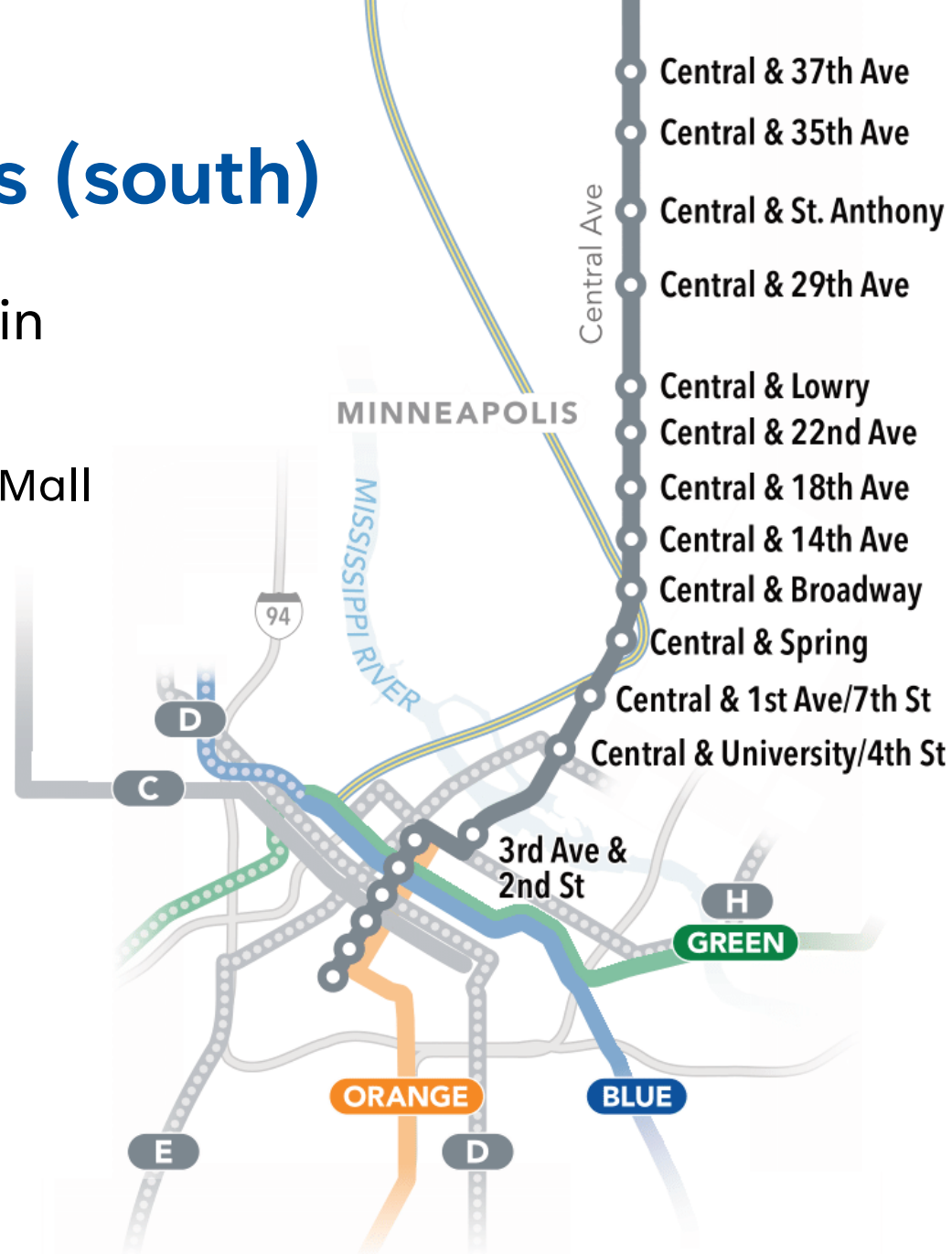

*in or on the border of

Draft Corridor Plan – seeking input now!

- Identifies proposed station locations
- Early, important opportunity for community input
- Addresses key station location questions:
 - Which intersections will have BRT stations?
 - In which quadrants (corners) of the intersections will the platforms be located?
 - How were the locations determined?

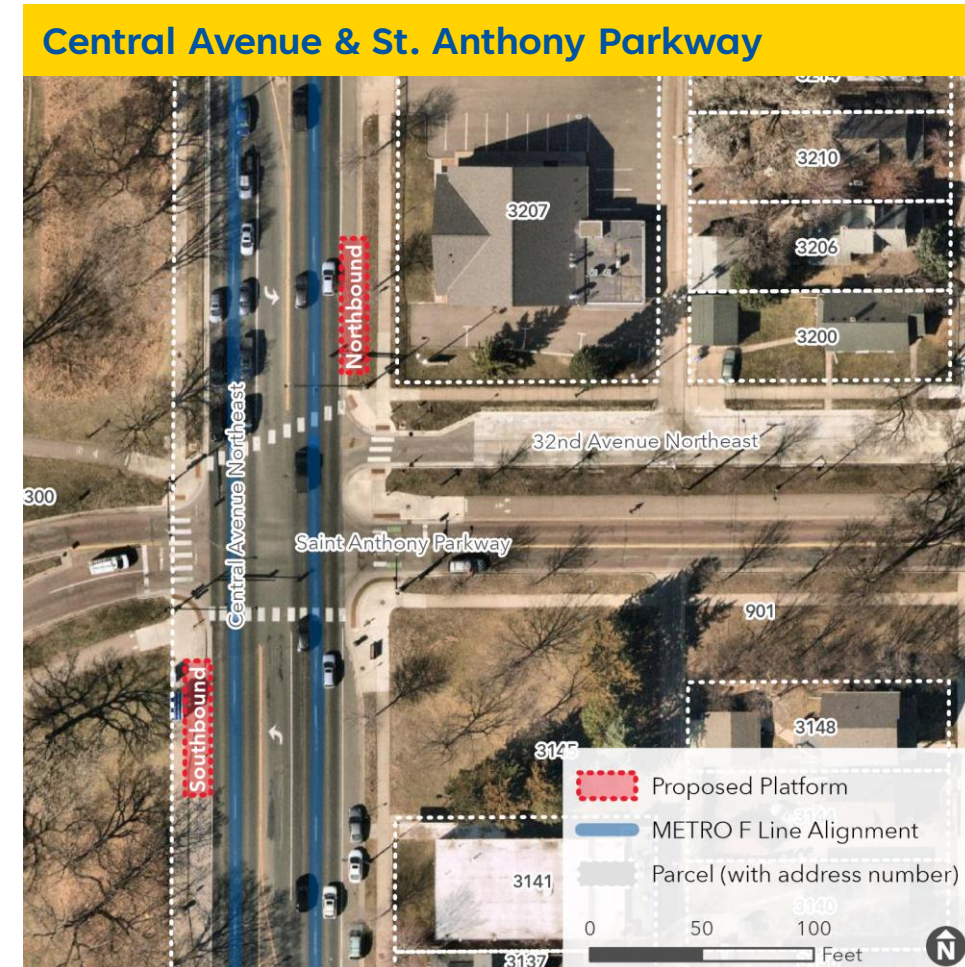

Draft Corridor Plan

- Proposed platform locations developed through site-specific review
- Concept designs will evolve and be refined through engineering and coordination
- Other planning issues (ongoing)
 - Project coordination with agency partners
 - Bus priority treatments
 - Supporting local service

Central Avenue & St. Anthony Parkway

Existing Station Area

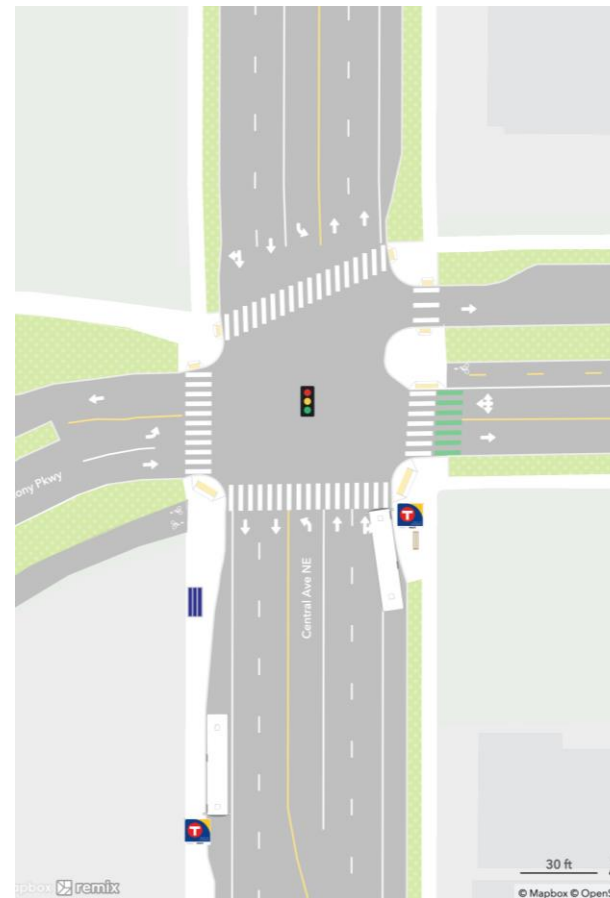

Proposed Station Plan

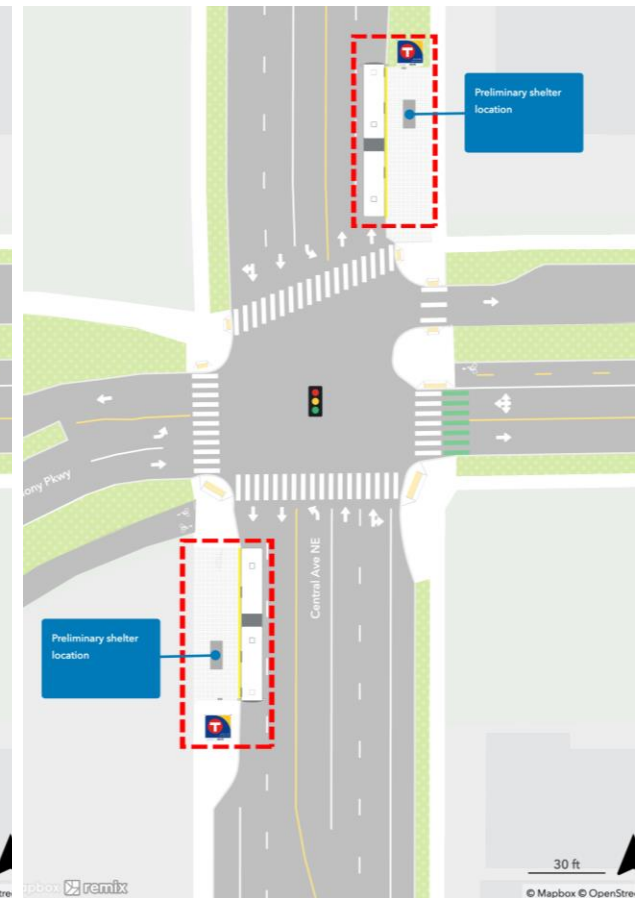

Public engagement

- Spring-fall 2022: Raised awareness about the project
- **Public comment period: October 24 – December 5**
- Available now on the project website:
 - Draft Corridor Plan (full document)
 - Station concepts
 - Survey to provide feedback on specific stations and/or overall project

metrotransit.org/f-line-project



Out in the community

- Meet Route 10 riders at stops and aboard buses
- Door knock and distribute flyers to all homes and businesses near proposed station locations
- Postcards sent to all homes and businesses along the corridor
- Share information via email newsletters and social media
- Partner with neighborhood, community, business, and advocacy groups
- Attend community events
- Documents available in Spanish, Somali, Hmong, Oromo, and Arabic



Changes coming to Route 10 in 2026.
Metro Transit is planning F Line station locations.

COMMENT NOW!
metrotransit.org/F-Line-Project



Se avecinan cambios en la Ruta 10 en 2026. Metro Transit planea la ubicación de las estaciones de la línea F. ¡Comparta sus opiniones!

Isbeddelo ayaa ku imanaya Jidka 10 sannadka 2026. Metro Transit waxa ay qorshaynaysaa goobaha Saldhigga leen F. La wadaag ra'yi-celintaada!

Jijjiramoota bara 2026 keessa Daandii 10faatti dhufaa jiran. Meetiiroo Tiraanzit bakkeewwan Buufata Toora F karoorsaa jira. Duubdeebii keessan nuuf qoodaa!

2026 yuuv muaj Kev hloov rau Npav 10. Metro Transit tabtom npaj Npav F cov chaw samthiaj tos. Thov qhia seb nej xav li cas!

**عقودوم Metro Transit طوطخت. 2026 ف ي 10 راسم يولع تارييغت ارطتس
طوطخت F: طوطخت**

T METRO F Line

Corridor Plan next steps

We are here



Seeking community input to establish station locations



Community engagement



Help us plan F Line station locations

- Public comment period: **October 24 – December 5**
- Review the Draft Corridor Plan and submit comments
 - Survey at metrotransit.org/f-line-project
 - Email FLine@metrotransit.org
 - Call Nasser Mussa, Community Outreach Coordinator at 651-829-5305
- F Line Update newsletter sign-up



Review and submit
comments at
[metrotransit.org/
f-line-project](https://metrotransit.org/f-line-project)

Q&A instructions and process

- Please submit questions and comments using the [chat](#)
 - As needed, use the [“Raise hand”](#) feature to verbally ask a question
 - We will then enable your microphone so you can unmute
- Please keep questions relevant to this project
- We will address as many submitted questions as possible
 - Responses will be organized to prioritize hearing from as many people as possible
 - Written responses to questions will be provided after the meeting

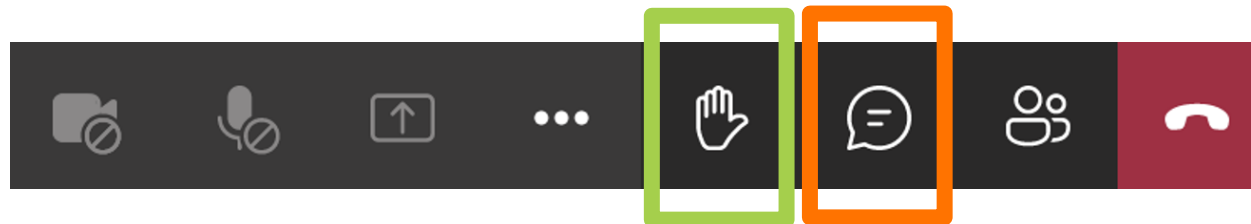

Help us plan F Line station locations

- Public comment period: **October 24 – December 5**
- Review the Draft Corridor Plan and submit comments
 - Survey at metrotransit.org/f-line-project
 - Email FLine@metrotransit.org
 - Call Nasser Mussa, Community Outreach Coordinator at 651-829-5305
- F Line Update newsletter



Review and submit
comments at
[metrotransit.org/
f-line-project](https://metrotransit.org/f-line-project)